

**SMA862VISG-9000**

SMA Jack  $\phi 16\text{mm}$  2 Hole Flange Right Angle With Round Contact ( $\phi 1.27$ ;  $L=17$ ); PTFE  $L=7.4$ ; 16GHz VSWR 1.2

**50 $\Omega$**

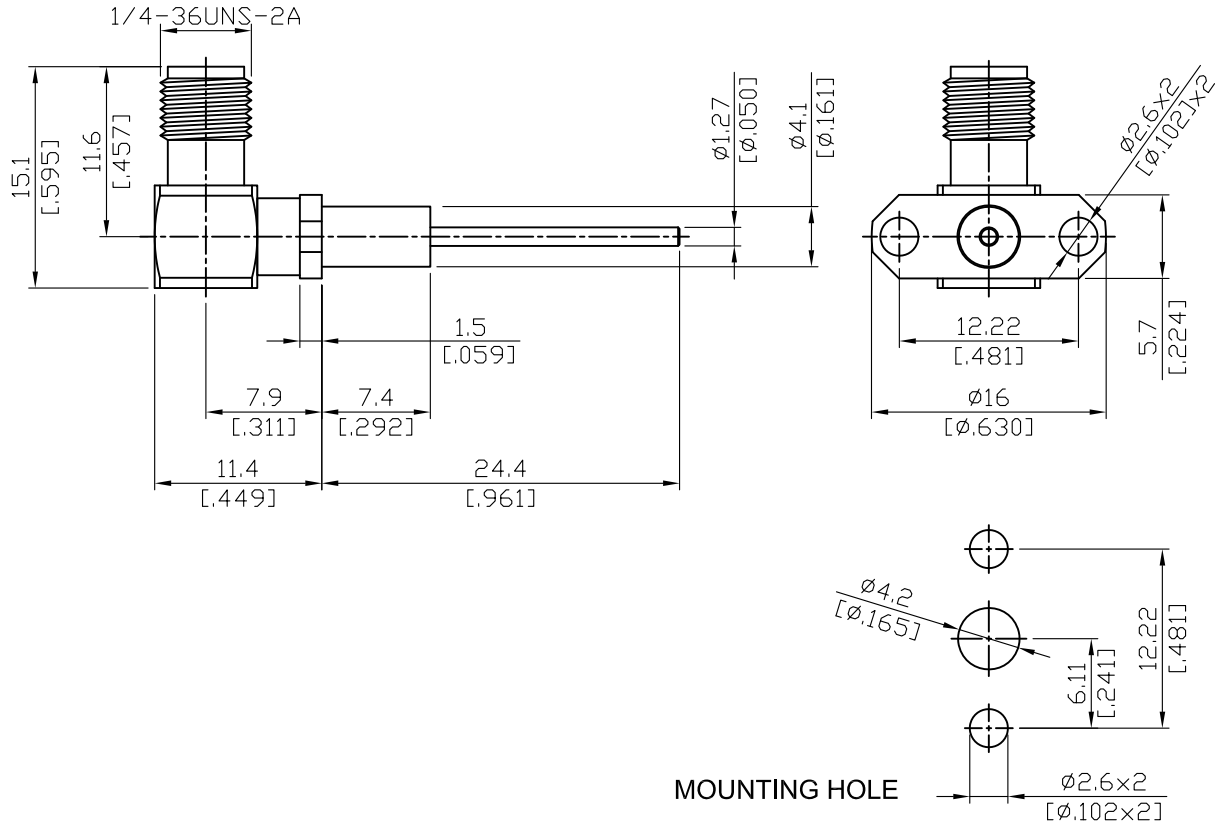

Parts	Material	Plating ( Micro-inch )
Cover	Brass	Gold 30 Over Nickel 50 Over Copper 50
Contact Pin	Beryllium Copper	Gold 50 Over Nickel 50 Over Copper 50
Insulator	Teflon	
Contact Pin	Brass	Gold 50 Over Nickel 50 Over Copper 50
Body	Stainless Steel	Gold 30 Over Nickel 50 Over Copper 50

This part number complies with RoHS.

Notice: JYEBAO reserves the right to make modifications deemed appropriate.

SMA	SMA862VISG-9000
<div data-bbox="167 344 568 389" style="border: 1px solid black; padding: 2px;">Interface</div> <p>MIL-STD-348B Mechanically compatible with</p>	
	2.92 & 3.5
<div data-bbox="167 512 568 557" style="border: 1px solid black; padding: 2px;">Electrical Data</div> <p>Impedance Frequency range VSWR Insertion loss Insulation resistance Contact resistance inner conductor Contact resistance outer conductor Dielectric withstanding voltage (at sea level) Working voltage (at sea level)</p>	
	<p>50Ω DC to 16GHz ≤ 1.2 (DC to 16GHz) ≤ 0.04 x √f(GHz) dB ≥ 5000MΩ ≤ 3mΩ ≤ 2mΩ 1500 V rms 500 V rms</p>
<div data-bbox="167 1057 568 1102" style="border: 1px solid black; padding: 2px;">Mechanical Data</div> <p>Recommended coupling nut torque Coupling proof torque Contact Captivation-axial Durability (mating)</p>	
	<p>7 to 9.5 inch lbs 15 inch lbs ≥ 6.1 lbs ≥ 500</p>
<div data-bbox="167 1413 568 1458" style="border: 1px solid black; padding: 2px;">Environmental Data</div> <p>Temperature range Thermal shock Moisture resistance Corrosion RoHS</p>	
	<p>-65°C to +165°C MIL-STD-202, Method 107, Condition B MIL-STD-202, Method 106 MIL-STD-202, Method 101, Condition B Compliant</p>
<div data-bbox="167 1765 568 1809" style="border: 1px solid black; padding: 2px;">Tooling</div>	

Notice: JYEBAO reserves the right to make modifications deemed appropriate.

# SMA862VISG-9000

S11

