

SMA8400B-0000

**SMA Jack PCB Mount With Round Contact (Φ0.5)**  
**18GHz VSWR 1.2**

**50Ω**

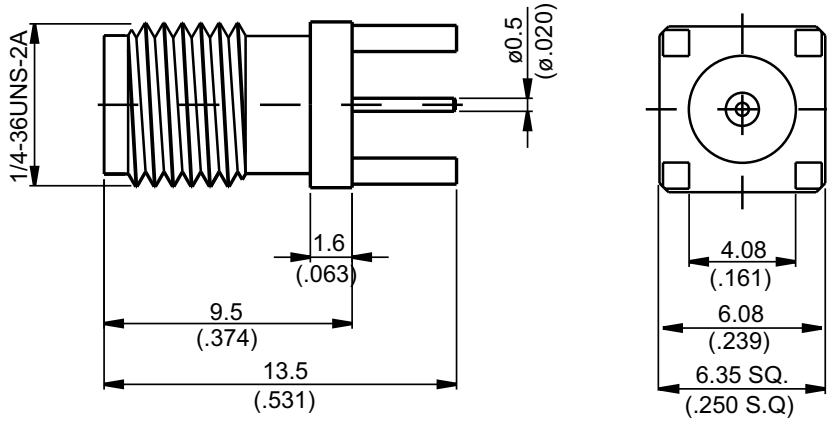

MOUNTING HOLE :

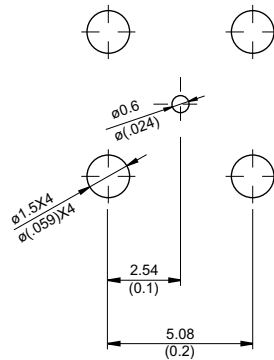

| Parts       | Material         | Plating (Micro-inch)                                  |
|-------------|------------------|---|
| Contact Pin | Beryllium Copper | Gold 4 Over Nickel-Phosphorus Alloy 80 Over Copper 20 |
| Insulator   | Teflon           |   |
| Body        | Brass            | Gold 4 Over Nickel-Phosphorus Alloy 80 Over Copper 20 |

Weight: 1.4 g

This part number complies with RoHS.

Notice: JYEBAO reserves the right to make modifications deemed appropriate.

| SMA  | SMA8400B-0000 |
|--|---------------|
| <div style="border: 1px solid black; padding: 2px; margin-bottom: 5px;">Interface</div> MIL-STD-348B<br>Mechanically compatible with 2.92 & 3.5  |               |
| <div style="border: 1px solid black; padding: 2px; margin-bottom: 5px;">Electrical Data</div> Impedance 50Ω<br>Frequency range DC to 18GHz<br>VSWR $\leq 1.2$ (DC to 18GHz)<br>Insertion loss $\leq 0.04 \times \sqrt{f(\text{GHz})}$ dB<br>Insulation resistance $\geq 5000\text{M}\Omega$<br>Contact resistance inner conductor $\leq 3\text{m}\Omega$<br>Contact resistance outer conductor $\leq 2\text{m}\Omega$<br>Dielectric withstanding voltage (at sea level) 1500 V rms<br>Working voltage (at sea level) 500 V rms |               |
| <div style="border: 1px solid black; padding: 2px; margin-bottom: 5px;">Mechanical Data</div> Recommended coupling nut torque 4 inch lbs<br>Coupling proof torque 5.3 inch lbs<br>Contact Captivation-axial $\geq 6.1$ lbs<br>Durability (mating) $\geq 100$   |               |
| <div style="border: 1px solid black; padding: 2px; margin-bottom: 5px;">Environmental Data</div> Temperature range -65°C to +165°C<br>Thermal shock MIL-STD-202, Method 107, Condition B<br>Moisture resistance MIL-STD-202, Method 106<br>Corrosion MIL-STD-202, Method 101, Condition B<br>RoHS Compliant  |               |
| <div style="border: 1px solid black; padding: 2px; margin-bottom: 5px;">Tooling</div>  |               |

Notice: JYEBAO reserves the right to make modifications deemed appropriate.

# SMA8400B-0000

S11

