

ALS-A3A8-27-1.15

Mitered SMA Plug To SMA Jack
27GHz VSWR 1.15

50Ω

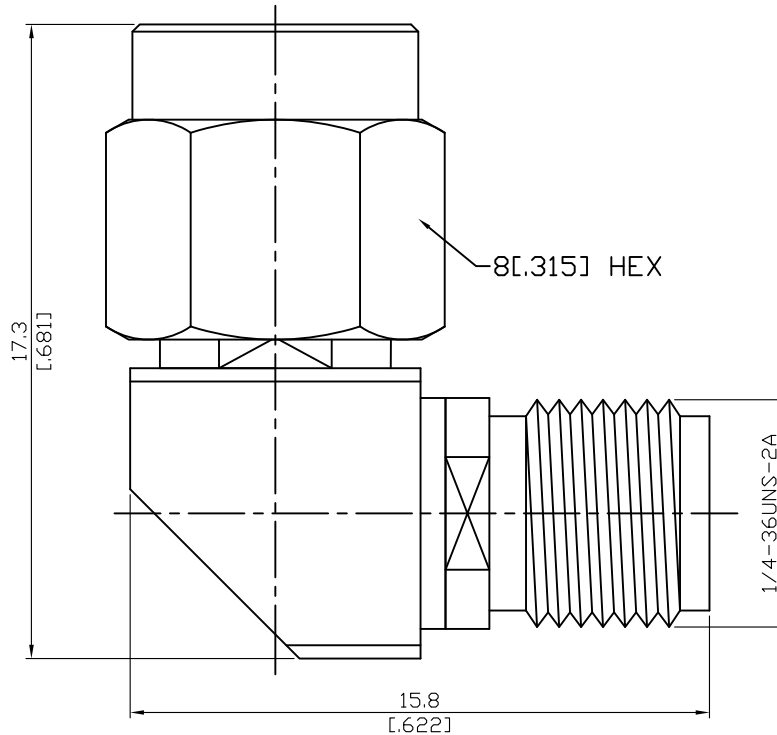

Parts	Material	Plating (Micro-inch)
Retainer Ring	Beryllium Copper	Tin-Zinc-Copper-Alloy 100 Over Copper 50
Gasket	Silicone	
Contact Pin	Beryllium Copper	Gold 4 Over Nickel-Phosphorus Alloy 80 Over Copper 20
Insulator	Teflon	
Body	Stainless Steel	Passivated
Coupling Nut	Stainless Steel	Passivated

This part number complies with RoHS.

Notice: JYEBAO reserves the right to make modifications deemed appropriate.

ALS-A3A8-27-1.15	Mitered SMA Plug To SMA Jack 27GHz VSWR 1.15
<div data-bbox="129 344 531 394" style="border: 1px solid black; padding: 2px;">Interface</div> <p data-bbox="129 405 1011 488">Standard MIL-STD-348B Mechanically compatible with 2.92 & 3.5</p>	
<div data-bbox="129 604 531 654" style="border: 1px solid black; padding: 2px;">Electrical Data</div> <p data-bbox="129 663 1126 981">Impedance 50Ω Frequency Range DC To 27GHz VSWR ≤ 1.15 (DC To 27GHz) Insertion Loss $\leq 0.06 \times \sqrt{f(\text{GHz})}$ dB Insulation Resistance $\geq 5000\text{M}\Omega$ Dielectric Withstanding Voltage (at sea level) 1500 V rms Working Voltage (at sea level) 500 V rms</p>	
<div data-bbox="129 1104 531 1153" style="border: 1px solid black; padding: 2px;">Mechanical Data</div> <p data-bbox="129 1162 991 1384">Recommended Coupling Nut Torque 7 to 9.5 in-lbs Coupling Proof Torque 15 in-lbs Coupling Nut Retention Force ≥ 60.7 lbs Contact Captivation-axial ≥ 6.1 lbs Durability (mating) ≥ 500</p>	
<div data-bbox="129 1505 531 1554" style="border: 1px solid black; padding: 2px;">Environmental Data</div> <p data-bbox="129 1563 1366 1785">Temperature Range -65°C to +165°C Thermal Shock MIL-STD-202, Method 107, Condition B Moisture Resistance MIL-STD-202, Method 206 Corrosion MIL-STD-202, Method 101, Condition B RoHS Compliant</p>	

ALS-A3A8-27-1.15

