

| | | |
|----------------------|---|-----|
| ALS-2.4/3-2.4/3-1.25 | Mitered 2.4mm Plug To 2.4mm Plug 50GHz VSWR 1.25 | 50Ω |
|----------------------|---|-----|

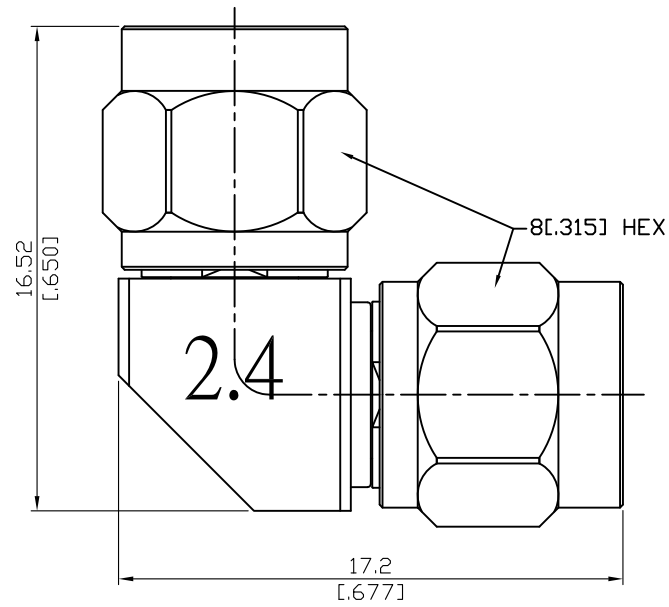

| Parts | Material | Plating (Micro-inch) |
|----------------|------------------|---|
| Insulator | PPO | |
| Gasket | Silicone | |
| Centre Contact | Beryllium Copper | Gold 4 Over Nickel-Phosphorus Alloy 80 Over Copper 20 |
| Retainer Ring | Beryllium Copper | Tin-Zinc-Copper-Alloy 100 Over Copper 50 |
| Body | Stainless Steel | Passivated |
| Coupling Nut | Stainless Steel | Passivated |

| | |
|--|--|
| | |
|--|--|

This part number complies with RoHS.

Notice: JYEBAO reserves the right to make modifications deemed appropriate.

| ALS-2.4/3-2.4/3-1.25 | Mitered 2.4mm Plug To 2.4mm Plug 50GHz VSWR 1.25 |
|---|---|
| <div data-bbox="129 342 531 394" style="border: 1px solid black; padding: 2px;">Interface</div> <p data-bbox="129 400 1011 488">Standard MIL-STD-348B Mechanically compatible with 1.85</p> | |
| <div data-bbox="129 602 531 654" style="border: 1px solid black; padding: 2px;">Electrical Data</div> <p data-bbox="129 660 1125 1032">Impedance 50Ω Frequency Range DC to 50GHz VSWR ≤ 1.25 (DC To 50GHz) Insertion Loss ≤ 0.07 x √f(GHz) dB Insulation Resistance ≥ 5000MΩ Dielectric Withstanding Voltage (at sea level) 500 V rms Working Voltage (at sea level) 150 V rms RF Leakage ≥ 100dB to 1GHz</p> | |
| <div data-bbox="129 1151 531 1202" style="border: 1px solid black; padding: 2px;">Mechanical Data</div> <p data-bbox="129 1209 1053 1435">Recommended Coupling Nut Torque 7.08 to 9.74 in-lbs Coupling Proof Torque 15 in-lbs Coupling Nut Retention Force ≥ 60.7 lbs Contact Captivation-axial ≥ 4.5 lbs Durability (mating) ≥ 500</p> | |
| <div data-bbox="129 1554 531 1606" style="border: 1px solid black; padding: 2px;">Environmental Data</div> <p data-bbox="129 1612 1364 1834">Temperature Range -55°C to +105°C Thermal Shock MIL-STD-202, Method 107, Condition B Moisture Resistance MIL-STD-202, Method 206 Corrosion MIL-STD-202, Method 101, Condition B RoHS Compliant</p> | |

ALS-2.4/3-2.4/3-1.25

