

ALS-2.4/3-2.4/3-1.15

Mitered 2.4mm Plug To 2.4mm Plug  
50GHz VSWR 1.15

50Ω

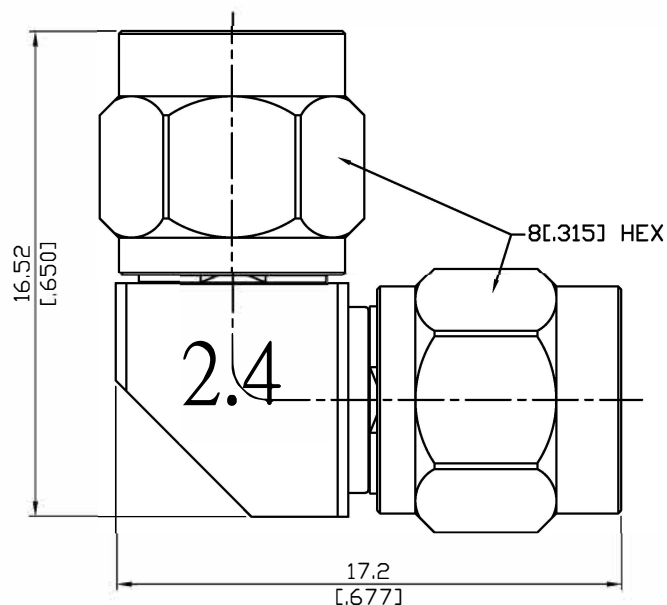

Parts	Material	Plating ( Micro-inch )
Insulator	PPO	
Gasket	Silicone	
Centre Contact	Beryllium Copper	Gold 4 Over Nickel-Phosphorus Alloy 80 Over Copper 20
Retainer Ring	Beryllium Copper	Tin-Zinc-Copper-Alloy 100 Over Copper 50
Body	Stainless Steel	Passivated
Coupling Nut	Stainless Steel	Passivated

This part number complies with RoHS.

Notice: JYEBAO reserves the right to make modifications deemed appropriate.

ALS-2.4/3-2.4/3-1.15	Mitered 2.4mm Plug To 2.4mm Plug 50GHz VSWR 1.15																
<div data-bbox="129 344 531 394">Interface</div> <div data-bbox="129 400 1011 483"> <table> <tr> <td>Standard</td><td>MIL-STD-348B</td></tr> <tr> <td>Mechanically compatible with</td><td>1.85</td></tr> </table> </div>	Standard	MIL-STD-348B	Mechanically compatible with	1.85													
Standard	MIL-STD-348B																
Mechanically compatible with	1.85																
<div data-bbox="129 607 531 656">Electrical Data</div> <div data-bbox="129 663 1123 1028"> <table> <tr> <td>Impedance</td><td>50Ω</td></tr> <tr> <td>Frequency Range</td><td>DC to 50GHz</td></tr> <tr> <td>VSWR</td><td>≤ 1.15 (DC To 50GHz)</td></tr> <tr> <td>Insertion Loss</td><td>≤ 0.07 x √f(GHz) dB</td></tr> <tr> <td>Insulation Resistance</td><td>≥ 5000MΩ</td></tr> <tr> <td>Dielectric Withstanding Voltage (at sea level)</td><td>500 V rms</td></tr> <tr> <td>Working Voltage (at sea level)</td><td>150 V rms</td></tr> <tr> <td>RF Leakage</td><td>≥ 100dB to 1GHz</td></tr> </table> </div>	Impedance	50Ω	Frequency Range	DC to 50GHz	VSWR	≤ 1.15 (DC To 50GHz)	Insertion Loss	≤ 0.07 x √f(GHz) dB	Insulation Resistance	≥ 5000MΩ	Dielectric Withstanding Voltage (at sea level)	500 V rms	Working Voltage (at sea level)	150 V rms	RF Leakage	≥ 100dB to 1GHz	
Impedance	50Ω																
Frequency Range	DC to 50GHz																
VSWR	≤ 1.15 (DC To 50GHz)																
Insertion Loss	≤ 0.07 x √f(GHz) dB																
Insulation Resistance	≥ 5000MΩ																
Dielectric Withstanding Voltage (at sea level)	500 V rms																
Working Voltage (at sea level)	150 V rms																
RF Leakage	≥ 100dB to 1GHz																
<div data-bbox="129 1153 531 1202">Mechanical Data</div> <div data-bbox="129 1209 1053 1433"> <table> <tr> <td>Recommended Coupling Nut Torque</td><td>7.08 to 9.74 in-lbs</td></tr> <tr> <td>Coupling Proof Torque</td><td>15 in-lbs</td></tr> <tr> <td>Coupling Nut Retention Force</td><td>≥ 60.7 lbs</td></tr> <tr> <td>Contact Captivation-axial</td><td>≥ 4.5 lbs</td></tr> <tr> <td>Durability (mating)</td><td>≥ 500</td></tr> </table> </div>	Recommended Coupling Nut Torque	7.08 to 9.74 in-lbs	Coupling Proof Torque	15 in-lbs	Coupling Nut Retention Force	≥ 60.7 lbs	Contact Captivation-axial	≥ 4.5 lbs	Durability (mating)	≥ 500							
Recommended Coupling Nut Torque	7.08 to 9.74 in-lbs																
Coupling Proof Torque	15 in-lbs																
Coupling Nut Retention Force	≥ 60.7 lbs																
Contact Captivation-axial	≥ 4.5 lbs																
Durability (mating)	≥ 500																
<div data-bbox="129 1556 531 1606">Environmental Data</div> <div data-bbox="129 1612 1362 1832"> <table> <tr> <td>Temperature Range</td><td>-55°C to +105°C</td></tr> <tr> <td>Thermal Shock</td><td>MIL-STD-202, Method 107, Condition B</td></tr> <tr> <td>Moisture Resistance</td><td>MIL-STD-202, Method 206</td></tr> <tr> <td>Corrosion</td><td>MIL-STD-202, Method 101, Condition B</td></tr> <tr> <td>RoHS</td><td>Compliant</td></tr> </table> </div>	Temperature Range	-55°C to +105°C	Thermal Shock	MIL-STD-202, Method 107, Condition B	Moisture Resistance	MIL-STD-202, Method 206	Corrosion	MIL-STD-202, Method 101, Condition B	RoHS	Compliant							
Temperature Range	-55°C to +105°C																
Thermal Shock	MIL-STD-202, Method 107, Condition B																
Moisture Resistance	MIL-STD-202, Method 206																
Corrosion	MIL-STD-202, Method 101, Condition B																
RoHS	Compliant																

# ALS-2.4/3-2.4/3-1.15

