

AL-A6A9

SMA Reverse Polarity Plug To SMA Reverse Polarity Jack 50Ω  
Right Angle; 6GHz VSWR 1.2

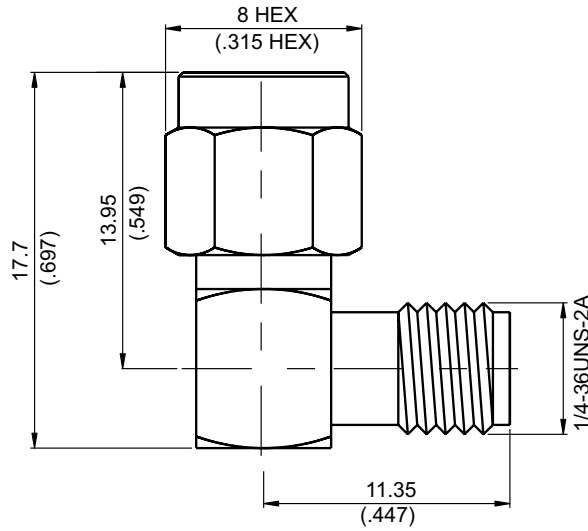

Parts	Material	Plating (Micro-inch)
Cover	Brass	Gold 4 Over Nickel-Phosphorus Alloy 80 Over Copper 20
Renbrock Ring	Beryllium Copper	Gold 4 Over Nickel-Phosphorus Alloy 80 Over Copper 20
Gasket	Silicon	
Contact Pin(RP Plug)	Beryllium Copper	Gold 4 Over Nickel-Phosphorus Alloy 80 Over Copper 20
Insulator	Teflon	
Contact Pin(RP Jack)	Brass	Gold 4 Over Nickel-Phosphorus Alloy 80 Over Copper 20
Body	Brass	Gold 4 Over Nickel-Phosphorus Alloy 80 Over Copper 20
Coupling Nut	Brass	Gold 4 Over Nickel-Phosphorus Alloy 80 Over Copper 20

Weight:

**This part number complies with RoHS.**

**Notice: JYEBAO reserves the right to make modifications deemed appropriate.**

AL-A6A9	<b>SMA Reverse Polarity Plug To SMA Reverse Polarity Jack Right Angle; 6GHz VSWR 1.2</b>															
<div style="border: 1px solid black; padding: 2px; margin-bottom: 5px;">Interface</div> <p>Per JYEBAO SMA Reverse Polarity derived from MIL-STD-348B</p>																
<div style="border: 1px solid black; padding: 2px; margin-bottom: 5px;">Electrical Data</div> <table style="width: 100%; border-collapse: collapse;"> <tr> <td style="width: 50%;">Impedance</td> <td style="width: 50%; text-align: right;">50Ω</td> </tr> <tr> <td>Frequency Range</td> <td style="text-align: right;">DC To 6GHz</td> </tr> <tr> <td>VSWR</td> <td style="text-align: right;">≤ 1.2 (DC To 6GHz)</td> </tr> <tr> <td>Insertion Loss</td> <td style="text-align: right;">≤ 0.06 x √f(GHz) dB</td> </tr> <tr> <td>Insulation Resistance</td> <td style="text-align: right;">≥ 5000MΩ</td> </tr> <tr> <td>Dielectric Withstanding Voltage (at sea level)</td> <td style="text-align: right;">1500 V rms</td> </tr> <tr> <td>Working Voltage (at sea level)</td> <td style="text-align: right;">500 V rms</td> </tr> </table>			Impedance	50Ω	Frequency Range	DC To 6GHz	VSWR	≤ 1.2 (DC To 6GHz)	Insertion Loss	≤ 0.06 x √f(GHz) dB	Insulation Resistance	≥ 5000MΩ	Dielectric Withstanding Voltage (at sea level)	1500 V rms	Working Voltage (at sea level)	500 V rms
Impedance	50Ω															
Frequency Range	DC To 6GHz															
VSWR	≤ 1.2 (DC To 6GHz)															
Insertion Loss	≤ 0.06 x √f(GHz) dB															
Insulation Resistance	≥ 5000MΩ															
Dielectric Withstanding Voltage (at sea level)	1500 V rms															
Working Voltage (at sea level)	500 V rms															
<div style="border: 1px solid black; padding: 2px; margin-bottom: 5px;">Mechanical Data</div> <table style="width: 100%; border-collapse: collapse;"> <tr> <td style="width: 50%;">Recommended Coupling Nut Torque</td> <td style="width: 50%; text-align: right;">4 in-lbs</td> </tr> <tr> <td>Coupling Proof Torque</td> <td style="text-align: right;">5.3 in-lbs</td> </tr> <tr> <td>Coupling Nut Retention Force</td> <td style="text-align: right;">≥ 60.7 lbs</td> </tr> <tr> <td>Contact Captivation-axial</td> <td style="text-align: right;">≥ 6.1 lbs</td> </tr> <tr> <td>Durability (mating)</td> <td style="text-align: right;">≥ 100</td> </tr> </table>			Recommended Coupling Nut Torque	4 in-lbs	Coupling Proof Torque	5.3 in-lbs	Coupling Nut Retention Force	≥ 60.7 lbs	Contact Captivation-axial	≥ 6.1 lbs	Durability (mating)	≥ 100				
Recommended Coupling Nut Torque	4 in-lbs															
Coupling Proof Torque	5.3 in-lbs															
Coupling Nut Retention Force	≥ 60.7 lbs															
Contact Captivation-axial	≥ 6.1 lbs															
Durability (mating)	≥ 100															
<div style="border: 1px solid black; padding: 2px; margin-bottom: 5px;">Environmental Data</div> <table style="width: 100%; border-collapse: collapse;"> <tr> <td style="width: 50%;">Temperature Range</td> <td style="width: 50%; text-align: right;">-65°C to +165°C</td> </tr> <tr> <td>Thermal Shock</td> <td style="text-align: right;">MIL-STD-202, Method 107, Condition B</td> </tr> <tr> <td>Moisture Resistance</td> <td style="text-align: right;">MIL-STD-202, Method 206</td> </tr> <tr> <td>Corrosion</td> <td style="text-align: right;">MIL-STD-202, Method 101, Condition B</td> </tr> <tr> <td>RoHS</td> <td style="text-align: right;">Compliant</td> </tr> </table>			Temperature Range	-65°C to +165°C	Thermal Shock	MIL-STD-202, Method 107, Condition B	Moisture Resistance	MIL-STD-202, Method 206	Corrosion	MIL-STD-202, Method 101, Condition B	RoHS	Compliant				
Temperature Range	-65°C to +165°C															
Thermal Shock	MIL-STD-202, Method 107, Condition B															
Moisture Resistance	MIL-STD-202, Method 206															
Corrosion	MIL-STD-202, Method 101, Condition B															
RoHS	Compliant															

Notice: JYEBAO reserves the right to make modifications deemed appropriate.

# AL-A6A9

