

ADS-PC3PC3-BF-1.15	3.5mm Plug To 3.5mm Plug Bulkhead 34.5GHz VSWR 1.15	50Ω
--------------------	--	-----

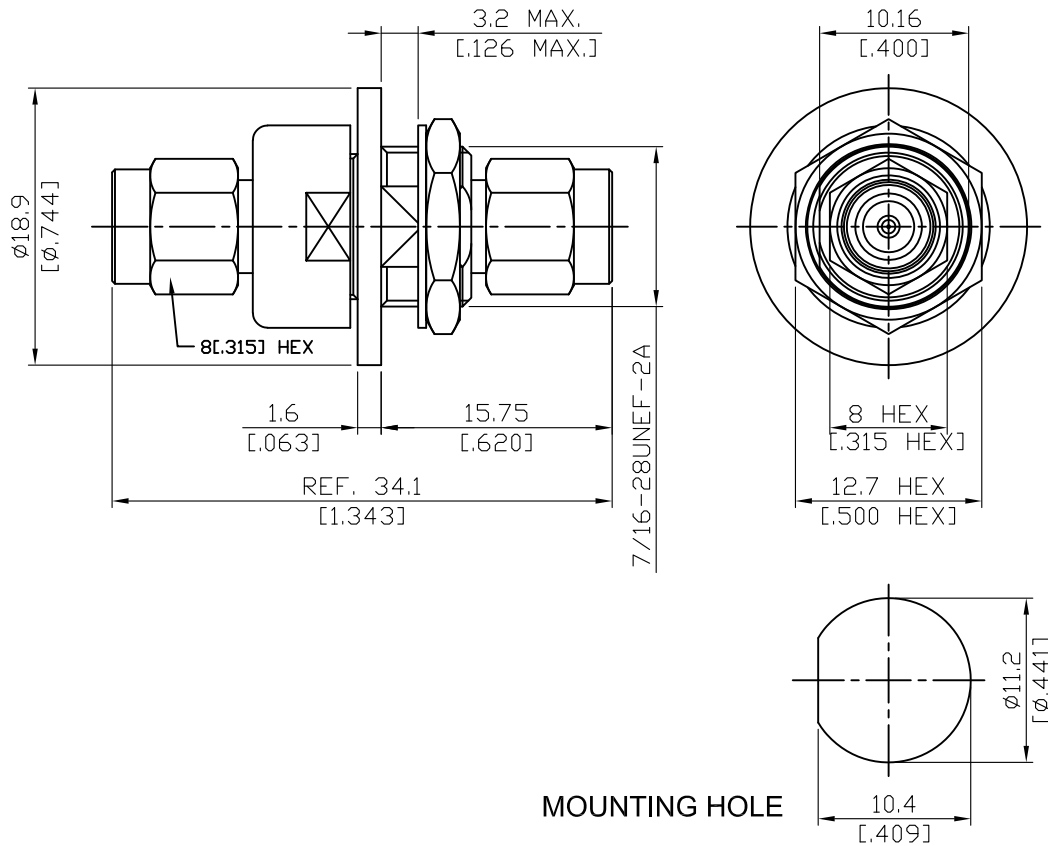

Parts	Material	Plating (Micro-inch)
Hex Nut	Stainless Steel	Passivated
Lock Washer	Stainless Steel	Passivated
Retainer Ring	Beryllium Copper	Tin-Zinc-Copper-Alloy 100 Over Copper 50
Gasket	Silicone	
Contact Pin	Beryllium Copper	Gold 4 Over Nickel-Phosphorus Alloy 80 Over Copper 20
Insulator	PPO	
Body	Stainless Steel	Passivated
Coupling Nut	Stainless Steel	Passivated

This part number complies with RoHS.

Notice: JYEBAO reserves the right to make modifications deemed appropriate.

ADS-PC3PC3-BF-1.15	3.5mm Plug To 3.5mm Plug Bulkhead 34.5GHz VSWR 1.15																		
<table border="0"> <tr> <td colspan="2" data-bbox="129 342 531 394">Interface</td> </tr> <tr> <td data-bbox="129 400 791 434">Standard</td> <td data-bbox="791 400 1479 434">IEC60169-23</td> </tr> <tr> <td data-bbox="129 448 791 481">Mechanically compatible with</td> <td data-bbox="791 448 1479 481">2.92 & SMA</td> </tr> </table>		Interface		Standard	IEC60169-23	Mechanically compatible with	2.92 & SMA												
Interface																			
Standard	IEC60169-23																		
Mechanically compatible with	2.92 & SMA																		
<table border="0"> <tr> <td colspan="2" data-bbox="129 604 531 656">Electrical Data</td> </tr> <tr> <td data-bbox="129 663 791 696">Impedance</td> <td data-bbox="791 663 1479 696">50Ω</td> </tr> <tr> <td data-bbox="129 710 791 743">Frequency Range</td> <td data-bbox="791 710 1479 743">DC to 34.5GHz</td> </tr> <tr> <td data-bbox="129 757 791 790">VSWR</td> <td data-bbox="791 757 1479 790">≤ 1.15 (DC To 34.5GHz)</td> </tr> <tr> <td data-bbox="129 804 791 837">Insertion Loss</td> <td data-bbox="791 804 1479 837">≤ 0.05 x √f(GHz) dB</td> </tr> <tr> <td data-bbox="129 851 791 884">Insulation Resistance</td> <td data-bbox="791 851 1479 884">≥ 5000MΩ</td> </tr> <tr> <td data-bbox="129 898 791 931">Dielectric Withstanding Voltage (at sea level)</td> <td data-bbox="791 898 1479 931">1000 V rms</td> </tr> <tr> <td data-bbox="129 945 791 978">Working Voltage (at sea level)</td> <td data-bbox="791 945 1479 978">335 V rms</td> </tr> <tr> <td data-bbox="129 992 791 1025">RF Leakage</td> <td data-bbox="791 992 1479 1025">≥ 100dB to 1GHz</td> </tr> </table>		Electrical Data		Impedance	50Ω	Frequency Range	DC to 34.5GHz	VSWR	≤ 1.15 (DC To 34.5GHz)	Insertion Loss	≤ 0.05 x √f(GHz) dB	Insulation Resistance	≥ 5000MΩ	Dielectric Withstanding Voltage (at sea level)	1000 V rms	Working Voltage (at sea level)	335 V rms	RF Leakage	≥ 100dB to 1GHz
Electrical Data																			
Impedance	50Ω																		
Frequency Range	DC to 34.5GHz																		
VSWR	≤ 1.15 (DC To 34.5GHz)																		
Insertion Loss	≤ 0.05 x √f(GHz) dB																		
Insulation Resistance	≥ 5000MΩ																		
Dielectric Withstanding Voltage (at sea level)	1000 V rms																		
Working Voltage (at sea level)	335 V rms																		
RF Leakage	≥ 100dB to 1GHz																		
<table border="0"> <tr> <td colspan="2" data-bbox="129 1153 531 1205">Mechanical Data</td> </tr> <tr> <td data-bbox="129 1211 791 1245">Recommended Coupling Nut Torque</td> <td data-bbox="791 1211 1479 1245">7.1 to 9.7 in-lbs</td> </tr> <tr> <td data-bbox="129 1258 791 1292">Coupling Proof Torque</td> <td data-bbox="791 1258 1479 1292">15 in-lbs</td> </tr> <tr> <td data-bbox="129 1305 791 1339">Coupling Nut Retention Force</td> <td data-bbox="791 1305 1479 1339">≥ 60.7 lbs</td> </tr> <tr> <td data-bbox="129 1352 791 1386">Contact Captivation-axial</td> <td data-bbox="791 1352 1479 1386">≥ 6.1 lbs</td> </tr> <tr> <td data-bbox="129 1400 791 1433">Durability (mating)</td> <td data-bbox="791 1400 1479 1433">≥ 500</td> </tr> </table>		Mechanical Data		Recommended Coupling Nut Torque	7.1 to 9.7 in-lbs	Coupling Proof Torque	15 in-lbs	Coupling Nut Retention Force	≥ 60.7 lbs	Contact Captivation-axial	≥ 6.1 lbs	Durability (mating)	≥ 500						
Mechanical Data																			
Recommended Coupling Nut Torque	7.1 to 9.7 in-lbs																		
Coupling Proof Torque	15 in-lbs																		
Coupling Nut Retention Force	≥ 60.7 lbs																		
Contact Captivation-axial	≥ 6.1 lbs																		
Durability (mating)	≥ 500																		
<table border="0"> <tr> <td colspan="2" data-bbox="129 1556 531 1608">Environmental Data</td> </tr> <tr> <td data-bbox="129 1615 791 1648">Temperature Range</td> <td data-bbox="791 1615 1479 1648">-55°C to +105°C</td> </tr> <tr> <td data-bbox="129 1662 791 1695">Thermal Shock</td> <td data-bbox="791 1662 1479 1695">MIL-STD-202, Method 107, Condition B</td> </tr> <tr> <td data-bbox="129 1709 791 1742">Moisture Resistance</td> <td data-bbox="791 1709 1479 1742">MIL-STD-202, Method 206</td> </tr> <tr> <td data-bbox="129 1756 791 1789">Corrosion</td> <td data-bbox="791 1756 1479 1789">MIL-STD-202, Method 101, Condition B</td> </tr> <tr> <td data-bbox="129 1803 791 1836">RoHS</td> <td data-bbox="791 1803 1479 1836">Compliant</td> </tr> </table>		Environmental Data		Temperature Range	-55°C to +105°C	Thermal Shock	MIL-STD-202, Method 107, Condition B	Moisture Resistance	MIL-STD-202, Method 206	Corrosion	MIL-STD-202, Method 101, Condition B	RoHS	Compliant						
Environmental Data																			
Temperature Range	-55°C to +105°C																		
Thermal Shock	MIL-STD-202, Method 107, Condition B																		
Moisture Resistance	MIL-STD-202, Method 206																		
Corrosion	MIL-STD-202, Method 101, Condition B																		
RoHS	Compliant																		

ADS-PC3PC3-BF-1.15

