

ADS-N8TQ3	N Jack To TNC Snap On Plug 11GHz VSWR 1.2	50Ω
-----------	--	-----

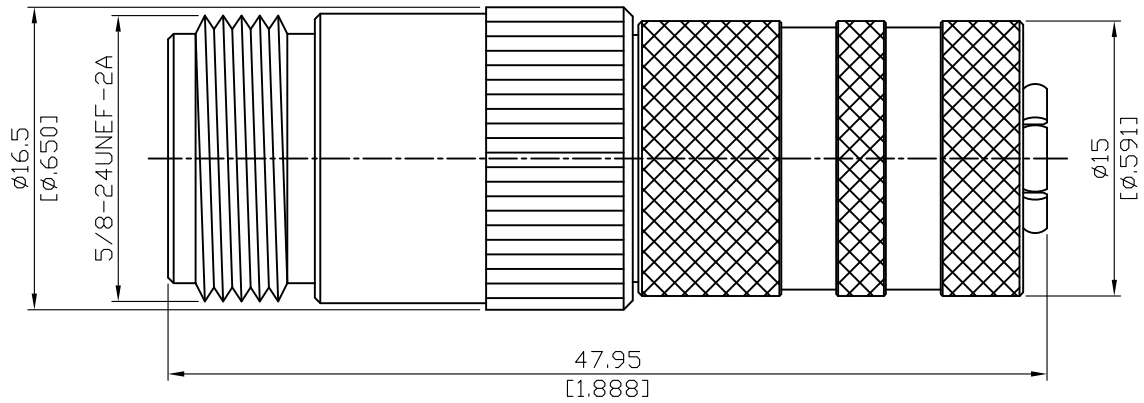

Note:

TNC snap on plug with locking mechanism

Snap on the coupling nut and give it a little turn

Parts	Material	Plating (Micro-inch)
Gasket	Silicone	
Spring	Stainless Steel	Passivated
Collet	Stainless Steel	Passivated
Coupling Nut	Stainless Steel	Passivated
Contact Pin	Beryllium Copper	Gold 4 Over Nickel-Phosphorus Alloy 80 Over Copper 20
Insulator	Teflon	
Body	Stainless Steel	Passivated

--	--

This part number complies with RoHS.

Notice: JYEBAO reserves the right to make modifications deemed appropriate.

ADS-N8TQ3	N Jack To TNC Snap On Plug 11GHz VSWR 1.2											
<div style="border: 1px solid black; padding: 2px; margin-bottom: 5px;">Interface</div> Standard	<div style="border: 1px solid black; padding: 2px; margin-bottom: 5px;">N Jack Screw Side</div> MIL-STD-348B	<div style="border: 1px solid black; padding: 2px; margin-bottom: 5px;">TNC Plug Snap On Side</div> Per JYEBAO TNC Snap On Plug										
<div style="border: 1px solid black; padding: 2px; margin-bottom: 5px;">Electrical Data</div> Impedance Frequency Range VSWR Insertion Loss Insulation Resistance Dielectric Withstanding Voltage (at sea level) Working Voltage (at sea level)	50Ω DC To 11GHz ≤ 1.2 (DC To 11GHz) ≤ 0.05 x √f(GHz) dB ≥ 5000MΩ 1500 V rms 500 V rms											
<div style="border: 1px solid black; padding: 2px; margin-bottom: 5px;">Mechanical Data</div> Recommended Coupling Nut Torque Coupling Proof Torque Contact Captivation-axial Durability (mating)	<table border="1" style="width: 100%; text-align: center;"> <thead> <tr> <th style="width: 50%;">N</th> <th style="width: 50%;">TNC</th> </tr> </thead> <tbody> <tr> <td>6 to 10 in-lbs</td> <td>NA (Snap On)</td> </tr> <tr> <td>15 in-lbs</td> <td>NA (Snap On)</td> </tr> <tr> <td>≥ 6.3 lbs</td> <td>≥ 6.1 lbs</td> </tr> <tr> <td>≥ 500</td> <td>≥ 1500</td> </tr> </tbody> </table>	N	TNC	6 to 10 in-lbs	NA (Snap On)	15 in-lbs	NA (Snap On)	≥ 6.3 lbs	≥ 6.1 lbs	≥ 500	≥ 1500	
N	TNC											
6 to 10 in-lbs	NA (Snap On)											
15 in-lbs	NA (Snap On)											
≥ 6.3 lbs	≥ 6.1 lbs											
≥ 500	≥ 1500											
<div style="border: 1px solid black; padding: 2px; margin-bottom: 5px;">Environmental Data</div> Temperature Range Thermal Shock Moisture Resistance Corrosion RoHS	-65°C to +165°C MIL-STD-202, Method 107, Condition B MIL-STD-202, Method 206 MIL-STD-202, Method 101, Condition B Compliant											