

ADS-AQ3A3

Snap On SMA Plug To SMA Plug
18GHz VSWR1.2

50Ω

*SMA Plug Snap On Design With Short Thread Ensuring Excellent Mating Reliability.
* Snap On And Give Short Turn For Proper Mating.

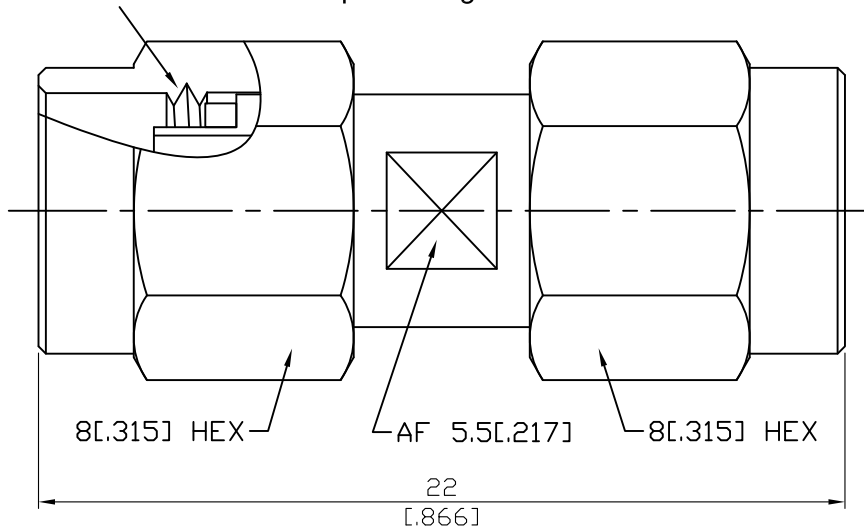

Parts	Material	Plating (Micro-inch)
Retainer Ring	Beryllium Copper	Tin-Zinc-Copper-Alloy 100 Over Copper 50
Gasket	Silicone	
Contact Pin	Beryllium Copper	Gold 4 Over Nickel-Phosphorus Alloy 80 Over Copper 20
Insulator	Teflon	
Body	Stainless Steel	Passivated
Coupling Nut	Stainless Steel	Passivated

This part number complies with RoHS.

Notice: JYEBAO reserves the right to make modifications deemed appropriate.

ADS-AQ3A3	Snap On SMA Plug To SMA Plug 18GHz VSWR1.2	
<div style="border: 1px solid black; padding: 2px;">Interface</div> <p>Standard Mechanically compatible with</p>	<div style="border: 1px solid black; padding: 2px; text-align: center;">SMA Plug Snap On Side</div> <p style="text-align: center;">Per JYEBAO Snap On SMA Plug</p> <p style="text-align: center;">2.92 & 3.5</p>	<div style="border: 1px solid black; padding: 2px; text-align: center;">SMA Plug Screw Side</div> <p style="text-align: center;">MIL-STD-348B</p> <p style="text-align: center;">2.92 & 3.5</p>
<div style="border: 1px solid black; padding: 2px;">Electrical Data</div> <p>Impedance 50Ω</p> <p>Frequency Range DC To 18GHz</p> <p>VSWR ≤ 1.2 (DC To 18GHz)</p> <p>Insertion Loss ≤ 0.04 x √f(GHz) dB</p> <p>Insulation Resistance ≥ 5000MΩ</p> <p>Dielectric Withstanding Voltage (at sea level) 1500 V rms</p> <p>Working Voltage (at sea level) 500 V rms</p>		
<div style="border: 1px solid black; padding: 2px;">Mechanical Data</div> <p>Recommended Coupling Nut Torque 7 to 9.5 in-lbs (Not applicable to snap on side)</p> <p>Coupling Proof Torque 15 in-lbs (Not applicable to snap on side)</p> <p>Coupling Nut Retention Force ≥ 60.7 lbs</p> <p>Contact Captivation-axial ≥ 6.1 lbs</p> <p>Durability (mating) ≥ 500</p>		
<div style="border: 1px solid black; padding: 2px;">Environmental Data</div> <p>Temperature Range -65°C to +165°C</p> <p>Thermal Shock MIL-STD-202, Method 107, Condition B</p> <p>Moisture Resistance MIL-STD-202, Method 206</p> <p>Corrosion MIL-STD-202, Method 101, Condition B</p> <p>RoHS Compliant</p>		

Notice: JYEBAO reserves the right to make modifications deemed appropriate.

ADS-AQ3A3

