

ADS-A8PL3-P2-27

SMA Jack To SMP Plug Limited Detent  
2 Hole Flange; 27GHz VSWR 1.2

50Ω

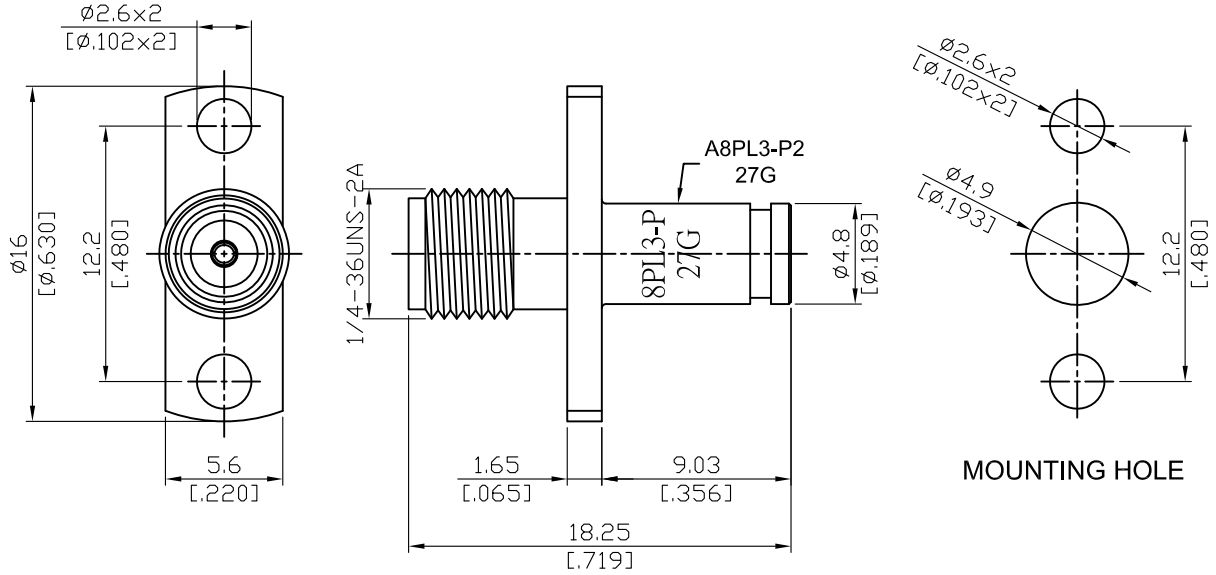

Parts	Material	Plating ( Micro-inch )
Contact Pin	Beryllium Copper	Gold 4 Over Nickel-Phosphorus Alloy 80 Over Copper 20
Insulator	Teflon	
Body	Stainless Steel	Passivated

This part number complies with RoHS.

Notice: JYEBAO reserves the right to make modifications deemed appropriate.

ADS-A8PL3-P2-27		SMA Jack To SMP Plug Limited Detent 2 Hole Flange; 27GHz VSWR 1.2			
<b>Interface</b> Standard Mechanically compatible with		SMA	SMP		
		MIL-STD-348B	MIL-STD-348B		
		2.92 & 3.5			
<b>Electrical Data</b> Impedance 50Ω Frequency Range DC To 27GHz VSWR ≤ 1.2 (DC To 27GHz) Insertion Loss ≤ 0.06 x √f(GHz) dB Insulation Resistance ≥ 5000MΩ Dielectric Withstanding Voltage (at sea level) 500 V rms Working Voltage (at sea level) 335 V rms					
<b>Mechanical Data</b>		SMA	SMP		
			Full detent	Limited detent	Smooth bore Catchers Mit
Recommended Coupling Nut Torque		7 to 9.5 in-lbs	NA	NA	NA
Coupling Proof Torque		15 in-lbs	NA	NA	NA
Contact Captivation-axial		≥ 6.1 lbs	NA	NA	NA
Durability (mating)		≥ 500	≥ 100	≥ 500	≥ 1000
Engagement Force		NA	≤ 15 lbs	≤ 10 lbs	≤ 2 lbs
Disengagement Force		NA	≥ 5 lbs	≥ 2 lbs	≥ 0.5 lbs
Axial Misalignment		NA	+0.00/-0.25(+.000/-0.010)		
Radial Misalignment		NA	+/-0.25(0.010)		
<b>Environmental Data</b> Temperature Range -65°C to +165°C Thermal Shock MIL-STD-202, Method 107, Condition B Moisture Resistance MIL-STD-202, Method 206 Corrosion MIL-STD-202, Method 101, Condition B RoHS Compliant					

Notice: JYEBAO reserves the right to make modifications deemed appropriate.