

ADS-A3K3-27-1.2

SMA Plug To K Plug  
27GHz VSWR 1.2

50Ω

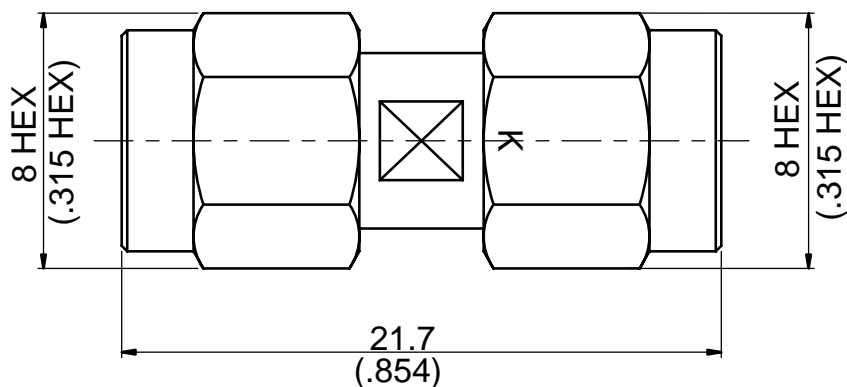

Parts	Material	Plating (Micro-inch)
Retainer Ring	Beryllium Copper	Tin-Zinc-Copper-Alloy 100 Over Copper 50
Gasket	Silicon	
Contact Pin	Beryllium Copper	Gold 4 Over Nickel-Phosphorus Alloy 80 Over Copper 20
Insulator	PTFE& PPO	
Body	Stainless Steel	Passivated
Coupling Nut	Stainless Steel	Passivated

Weight: 5.28 g

This part number complies with RoHS.

**Notice:** JYBAO reserves the right to make modifications deemed appropriate.

ADS-A3K3-27-1.2	SMA Plug To K Plug 27GHz VSWR 1.2	
<b>Interface</b> Standard Mechanically compatible with	2.92 MIL-STD-348B 3.5 & SMA	SMA MIL-STD-348B 2.92 & 3.5
<b>Electrical Data</b> Impedance Frequency Range VSWR Insertion Loss Insulation Resistance Dielectric Withstanding Voltage (at sea level) Working Voltage (at sea level)	50Ω DC To 27GHz ≤ 1.2 (DC To 27GHz) ≤ 0.05 x √f(GHz) dB ≥ 5000MΩ 750 V rms 250 V rms	
<b>Mechanical Data</b> Recommended Coupling Nut Torque Coupling Proof Torque Contact Captivation-axial Durability (mating)	2.92 11.47 in-lbs 15 in-lbs ≥ 4.9 lbs ≥ 500	SMA 7 to 9.5 in-lbs 15 in-lbs ≥ 6.1 lbs ≥ 500
<b>Environmental Data</b> Temperature Range Thermal Shock Moisture Resistance Corrosion RoHS	-55°C to +105°C MIL-STD-202, Method 107, Condition B MIL-STD-202, Method 206 MIL-STD-202, Method 101, Condition B Compliant	

# ADS-A3K3-27-1.2

