

ADS-1.0/8-1.85/3-1.25	1.0mm Jack To 1.85mm Plug 67GHz VSWR 1.25	50Ω
-----------------------	--	-----

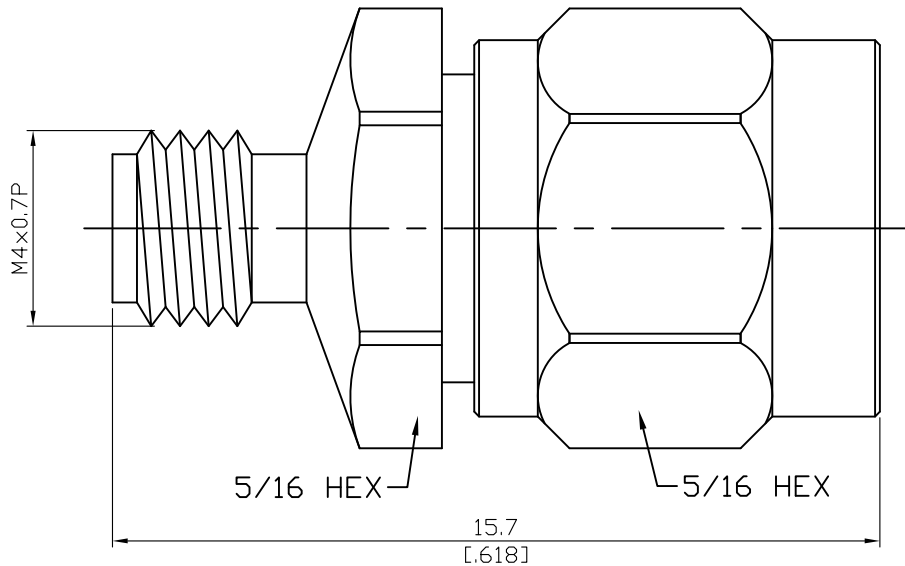

Parts	Material	Plating (Micro-inch)
Body	Stainless Steel	Passivated
Coupling Nut	Stainless Steel	Passivated
Contact Pin	Beryllium Copper	Gold 4 Over Nickel-Phosphorus Alloy 80 Over Copper 20
Insulator	PEI	
Retainer Ring	Beryllium Copper	Tin-Zinc-Copper-Alloy 100 Over Copper 50
Gasket	Silicone	

--	--

This part number complies with RoHS.

Notice: JYEBAO reserves the right to make modifications deemed appropriate.

ADS-1.0/8-1.85/3-1.25	1.0mm Jack To 1.85mm Plug 67GHz VSWR 1.25	
<div style="border: 1px solid black; padding: 2px; margin-bottom: 5px;">Interface</div> Standard Mechanically compatible with	1.0	1.85
	IEEE287; IEC61169-31	IEEE287; IEC61169-32
		2.4
<div style="border: 1px solid black; padding: 2px; margin-bottom: 5px;">Electrical Data</div> Impedance Frequency Range VSWR Insertion Loss Insulation Resistance Dielectric Withstanding Voltage (at sea level) Working Voltage (at sea level)	50Ω DC To 67GHz ≤ 1.25 (DC To 67GHz) $\leq 0.05 \times \sqrt{f(\text{GHz})}$ dB $\geq 5000\text{M}\Omega$ 500 V rms 150 V rms	
<div style="border: 1px solid black; padding: 2px; margin-bottom: 5px;">Mechanical Data</div> Recommended Coupling Nut Torque Coupling Proof Torque Contact Captivation-axial Durability (mating)	1.0	1.85
	2.65 to 3.63 in-lbs	7.08 to 9.74 in-lbs
	6.2 in-lbs	15 in-lbs
	≥ 2.25 lbs	≥ 4.5 lbs
	≥ 500	≥ 500
<div style="border: 1px solid black; padding: 2px; margin-bottom: 5px;">Environmental Data</div> Temperature Range Thermal Shock Moisture Resistance Corrosion RoHS	-40°C to +165°C MIL-STD-202, Method 107, Condition B MIL-STD-202, Method 206 MIL-STD-202, Method 101, Condition B Compliant	

ADS-1.0/8-1.85/3-1.25

