

AD-N3NQ8-NL	N Plug to N Snap On Jack Without Locking Mechanism; 18GHz VSWR 1.25	50Ω
-------------	--	-----

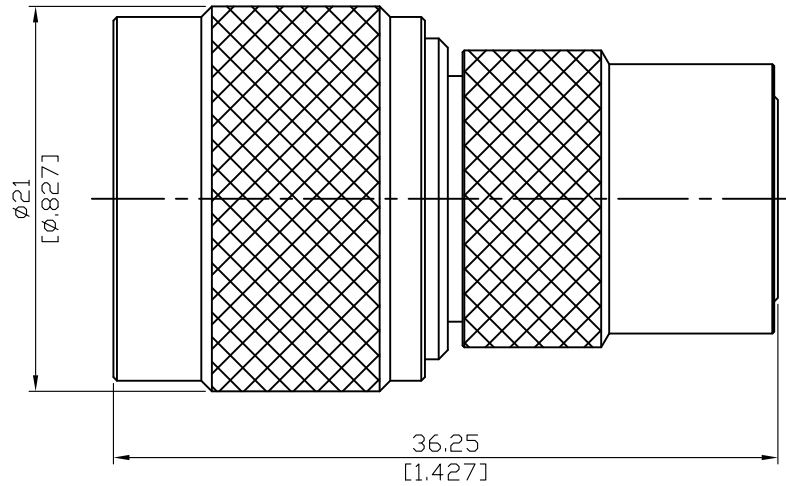

Parts	Material	Plating (Micro-inch)
Coupling Nut	Brass	Tin-Zinc-Copper-Alloy 100 Over Copper 50
Body	Brass	Tin-Zinc-Copper-Alloy 100 Over Copper 50
Insulator	Teflon	
Contact Pin	Beryllium Copper	Gold 4 Over Nickel-Phosphorus Alloy 80 Over Copper 20
Retainer Ring	Brass	Tin-Zinc-Copper-Alloy 100 Over Copper 50
Retainer Ring	Stainless Steel	Passivated
Gasket	Silicone	

--	--

This part number complies with RoHS.

Notice: JYEBAO reserves the right to make modifications deemed appropriate.

AD-N3NQ8-NL	N Plug to N Snap On Jack Without Locking Mechanism; 18GHz VSWR 1.25																
<table border="0"> <tr> <td colspan="2" data-bbox="130 344 531 389">Interface</td> </tr> <tr> <td data-bbox="130 405 791 477">Screw Side Snap On Side</td> <td data-bbox="791 405 1477 477">MIL-STD-348B Per JYEBAO N Snap On</td> </tr> </table>		Interface		Screw Side Snap On Side	MIL-STD-348B Per JYEBAO N Snap On												
Interface																	
Screw Side Snap On Side	MIL-STD-348B Per JYEBAO N Snap On																
<table border="0"> <tr> <td colspan="2" data-bbox="130 607 531 651">Electrical Data</td> </tr> <tr> <td data-bbox="130 663 791 696">Impedance</td> <td data-bbox="791 663 1477 696">50Ω</td> </tr> <tr> <td data-bbox="130 707 791 741">Frequency Range</td> <td data-bbox="791 707 1477 741">DC to 18GHz</td> </tr> <tr> <td data-bbox="130 752 791 786">VSWR</td> <td data-bbox="791 752 1477 786">≤ 1.25 (DC To 18GHz)</td> </tr> <tr> <td data-bbox="130 797 791 831">Insertion Loss</td> <td data-bbox="791 797 1477 831">≤ 0.05 x √f(GHz) dB</td> </tr> <tr> <td data-bbox="130 842 791 875">Insulation Resistance</td> <td data-bbox="791 842 1477 875">≥ 5000MΩ</td> </tr> <tr> <td data-bbox="130 887 791 920">Dielectric Withstanding Voltage (at sea level)</td> <td data-bbox="791 887 1477 920">2500 V rms</td> </tr> <tr> <td data-bbox="130 931 791 965">Working Voltage (at sea level)</td> <td data-bbox="791 931 1477 965">1000 V rms</td> </tr> </table>		Electrical Data		Impedance	50Ω	Frequency Range	DC to 18GHz	VSWR	≤ 1.25 (DC To 18GHz)	Insertion Loss	≤ 0.05 x √f(GHz) dB	Insulation Resistance	≥ 5000MΩ	Dielectric Withstanding Voltage (at sea level)	2500 V rms	Working Voltage (at sea level)	1000 V rms
Electrical Data																	
Impedance	50Ω																
Frequency Range	DC to 18GHz																
VSWR	≤ 1.25 (DC To 18GHz)																
Insertion Loss	≤ 0.05 x √f(GHz) dB																
Insulation Resistance	≥ 5000MΩ																
Dielectric Withstanding Voltage (at sea level)	2500 V rms																
Working Voltage (at sea level)	1000 V rms																
<table border="0"> <tr> <td colspan="2" data-bbox="130 1106 531 1151">Mechanical Data</td> </tr> <tr> <td data-bbox="130 1162 791 1196">Recommended Coupling Nut Torque</td> <td data-bbox="791 1162 1477 1196">6 to 10 in-lbs (not applicable to snap on side)</td> </tr> <tr> <td data-bbox="130 1207 791 1240">Coupling Proof Torque</td> <td data-bbox="791 1207 1477 1240">15 in-lbs (not applicable to snap on side)</td> </tr> <tr> <td data-bbox="130 1252 791 1285">Coupling Nut Retention Force</td> <td data-bbox="791 1252 1477 1285">≥ 101.2 lbs (not applicable to snap on side)</td> </tr> <tr> <td data-bbox="130 1296 791 1330">Contact Captivation-axial</td> <td data-bbox="791 1296 1477 1330">≥ 6.3 lbs</td> </tr> <tr> <td data-bbox="130 1341 791 1375">Durability (mating)</td> <td data-bbox="791 1341 1477 1375">≥ 500(screw on side); ≥ 20000(snap on side)</td> </tr> </table>		Mechanical Data		Recommended Coupling Nut Torque	6 to 10 in-lbs (not applicable to snap on side)	Coupling Proof Torque	15 in-lbs (not applicable to snap on side)	Coupling Nut Retention Force	≥ 101.2 lbs (not applicable to snap on side)	Contact Captivation-axial	≥ 6.3 lbs	Durability (mating)	≥ 500(screw on side); ≥ 20000(snap on side)				
Mechanical Data																	
Recommended Coupling Nut Torque	6 to 10 in-lbs (not applicable to snap on side)																
Coupling Proof Torque	15 in-lbs (not applicable to snap on side)																
Coupling Nut Retention Force	≥ 101.2 lbs (not applicable to snap on side)																
Contact Captivation-axial	≥ 6.3 lbs																
Durability (mating)	≥ 500(screw on side); ≥ 20000(snap on side)																
<table border="0"> <tr> <td colspan="2" data-bbox="130 1507 531 1552">Environmental Data</td> </tr> <tr> <td data-bbox="130 1563 791 1597">Temperature Range</td> <td data-bbox="791 1563 1477 1597">-65°C to +165°C</td> </tr> <tr> <td data-bbox="130 1608 791 1641">Thermal Shock</td> <td data-bbox="791 1608 1477 1641">MIL-STD-202, Method 107, Condition B</td> </tr> <tr> <td data-bbox="130 1653 791 1686">Moisture Resistance</td> <td data-bbox="791 1653 1477 1686">MIL-STD-202, Method 206</td> </tr> <tr> <td data-bbox="130 1697 791 1731">Corrosion</td> <td data-bbox="791 1697 1477 1731">MIL-STD-202, Method 101, Condition B</td> </tr> <tr> <td data-bbox="130 1742 791 1776">RoHS</td> <td data-bbox="791 1742 1477 1776">Compliant</td> </tr> </table>		Environmental Data		Temperature Range	-65°C to +165°C	Thermal Shock	MIL-STD-202, Method 107, Condition B	Moisture Resistance	MIL-STD-202, Method 206	Corrosion	MIL-STD-202, Method 101, Condition B	RoHS	Compliant				
Environmental Data																	
Temperature Range	-65°C to +165°C																
Thermal Shock	MIL-STD-202, Method 107, Condition B																
Moisture Resistance	MIL-STD-202, Method 206																
Corrosion	MIL-STD-202, Method 101, Condition B																
RoHS	Compliant																

Notice: JYEBAO reserves the right to make modifications deemed appropriate.

AD-N3NQ8-NL

