

AD-M3M3	UHF Plug To UHF Plug 0.3GHz VSWR 1.2	50Ω
---------	---	-----

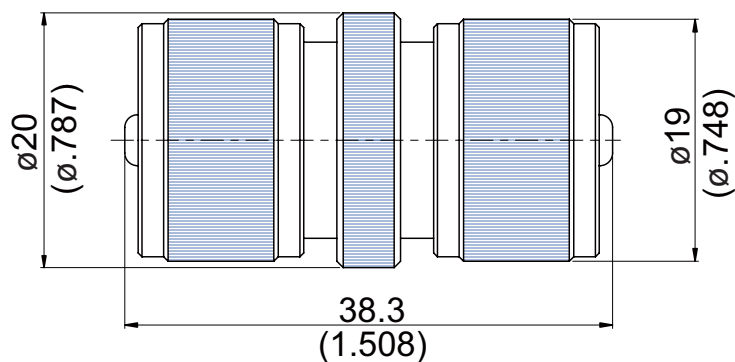

Parts	Material	Plating (Micro-inch)
Retainer Ring	Brass	Tin-Zinc-Copper-Alloy 100 Over Copper 50
Contact Pin	Brass	Gold 4 Over Nickel-Phosphorus Alloy 80 Over Copper 20
Body	Brass	Tin-Zinc-Copper-Alloy 100 Over Copper 50
Insulator	Teflon	
Coupling Nut	Brass	Tin-Zinc-Copper-Alloy 100 Over Copper 50

Weight:

This part number complies with RoHS.

Notice: JYEBAO reserves the right to make modifications deemed appropriate.

AD-M3M3	UHF Plug To UHF Plug 0.3GHz VSWR 1.2																
<table border="0"> <tr> <td data-bbox="129 342 531 394">Interface</td> <td></td> </tr> <tr> <td data-bbox="129 394 531 533">Standard</td> <td data-bbox="531 394 1482 533">IEC 60169-12</td> </tr> </table>		Interface		Standard	IEC 60169-12												
Interface																	
Standard	IEC 60169-12																
<table border="0"> <tr> <td data-bbox="129 555 531 607">Electrical Data</td> <td></td> </tr> <tr> <td data-bbox="129 607 531 658">Impedance</td> <td data-bbox="531 607 1482 658">Non constant</td> </tr> <tr> <td data-bbox="129 658 531 710">Frequency Range</td> <td data-bbox="531 658 1482 710">DC to 300MHz</td> </tr> <tr> <td data-bbox="129 710 531 761">VSWR</td> <td data-bbox="531 710 1482 761">≤ 1.2 (DC To 300MHz)</td> </tr> <tr> <td data-bbox="129 761 531 813">Insulation Resistance</td> <td data-bbox="531 761 1482 813">$\geq 5000M\Omega$</td> </tr> <tr> <td data-bbox="129 813 531 864">Dielectric Withstanding Voltage (at sea level)</td> <td data-bbox="531 813 1482 864">2000 V rms</td> </tr> <tr> <td data-bbox="129 864 531 916">Working Voltage (at sea level)</td> <td data-bbox="531 864 1482 916">750 V rms</td> </tr> <tr> <td data-bbox="129 916 531 967">Power Handling</td> <td data-bbox="531 916 1482 967">400W (300MHz)</td> </tr> </table>		Electrical Data		Impedance	Non constant	Frequency Range	DC to 300MHz	VSWR	≤ 1.2 (DC To 300MHz)	Insulation Resistance	$\geq 5000M\Omega$	Dielectric Withstanding Voltage (at sea level)	2000 V rms	Working Voltage (at sea level)	750 V rms	Power Handling	400W (300MHz)
Electrical Data																	
Impedance	Non constant																
Frequency Range	DC to 300MHz																
VSWR	≤ 1.2 (DC To 300MHz)																
Insulation Resistance	$\geq 5000M\Omega$																
Dielectric Withstanding Voltage (at sea level)	2000 V rms																
Working Voltage (at sea level)	750 V rms																
Power Handling	400W (300MHz)																
<table border="0"> <tr> <td data-bbox="129 1052 531 1104">Environmental Data</td> <td></td> </tr> <tr> <td data-bbox="129 1104 531 1155">Temperature Range</td> <td data-bbox="531 1104 1482 1155">-65°C to +165°C</td> </tr> <tr> <td data-bbox="129 1155 531 1207">Thermal Shock</td> <td data-bbox="531 1155 1482 1207">MIL-STD-202, Method 107, Condition B</td> </tr> <tr> <td data-bbox="129 1207 531 1258">Moisture Resistance</td> <td data-bbox="531 1207 1482 1258">MIL-STD-202, Method 206</td> </tr> <tr> <td data-bbox="129 1258 531 1310">Corrosion</td> <td data-bbox="531 1258 1482 1310">MIL-STD-202, Method 101, Condition B</td> </tr> <tr> <td data-bbox="129 1310 531 1361">RoHS</td> <td data-bbox="531 1310 1482 1361">Compliant</td> </tr> </table>		Environmental Data		Temperature Range	-65°C to +165°C	Thermal Shock	MIL-STD-202, Method 107, Condition B	Moisture Resistance	MIL-STD-202, Method 206	Corrosion	MIL-STD-202, Method 101, Condition B	RoHS	Compliant				
Environmental Data																	
Temperature Range	-65°C to +165°C																
Thermal Shock	MIL-STD-202, Method 107, Condition B																
Moisture Resistance	MIL-STD-202, Method 206																
Corrosion	MIL-STD-202, Method 101, Condition B																
RoHS	Compliant																

Notice: JYEBAO reserves the right to make modifications deemed appropriate.