

AD-A9A9	SMA Jack Polarity Reverse To SMA Jack Polarity Reverse; 6GHz VSWR 1.2	50Ω
---------	--	-----

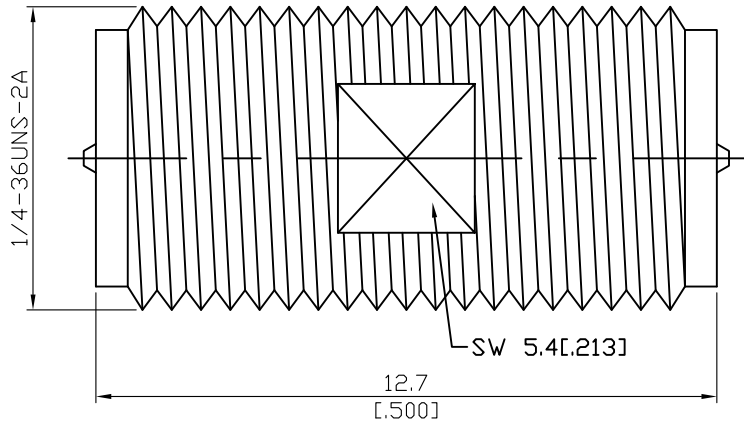

Parts	Material	Plating (Micro-inch)
Contact Pin	Brass	Gold 4 Over Nickel-Phosphorus Alloy 80 Over Copper 20
Insulator	Teflon	
Contact Pin	Brass	Gold 4 Over Nickel-Phosphorus Alloy 80 Over Copper 20

--	--

This part number complies with RoHS.

Notice: JYEBAO reserves the right to make modifications deemed appropriate.

AD-A9A9	SMA Reverse Polarity Jack to SMA Reverse Polarity Jack 6GHz VSWR 1.2
Interface Per JYEBAO SMA Reverse Polarity Jack derived from MIL-STD-348B	
Electrical Data	
Impedance	50Ω
Frequency Range	DC To 6GHz
VSWR	≤ 1.2 (DC To 6GHz)
Insertion Loss	≤ 0.04 x √f(GHz) dB
Insulation Resistance	≥ 5000MΩ
Dielectric Withstanding Voltage (at sea level)	1500 V rms
Working Voltage (at sea level)	500 V rms
Mechanical Data	
Recommended Coupling Nut Torque	4 in-lbs
Coupling Proof Torque	5.3 in-lbs
Contact Captivation-axial	≥ 6.1 lbs
Durability (mating)	≥ 100
Environmental Data	
Temperature Range	-65°C to +165°C
Thermal Shock	MIL-STD-202, Method 107, Condition B
Moisture Resistance	MIL-STD-202, Method 206
Corrosion	MIL-STD-202, Method 101, Condition B
RoHS	Compliant

Notice: JYEBAO reserves the right to make modifications deemed appropriate.

AD-A9A9

