

AD-A8A8-A1/HDPE

SMA Jack to SMA Jack, Radiation Resistant,  
18GHz VSWR 1.35

50Ω

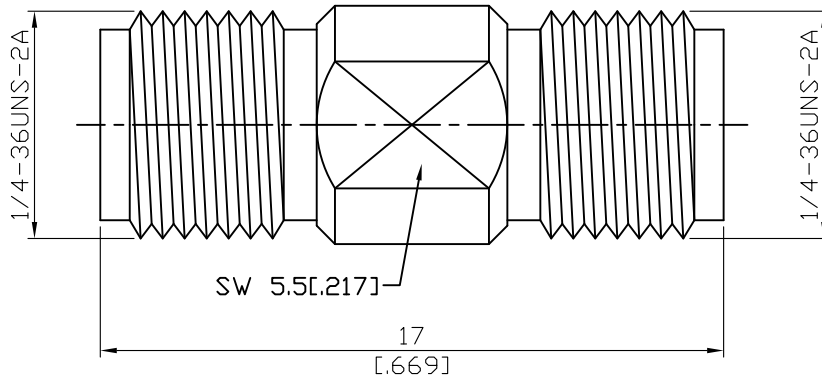

Parts	Material	Plating ( Micro-inch )
Body	Brass	Gold 4 Over Nickel-Phosphorus Alloy 80 Over Copper 20
Insulator	HDPE	
Contact Pin	Beryllium Copper	Gold 4 Over Nickel-Phosphorus Alloy 80 Over Copper 20

This part number complies with RoHS.

Notice: JYEBAO reserves the right to make modifications deemed appropriate.

AD-A8A8-A1/HDPE	SMA Jack to SMA Jack, Radiation Resistant, 18GHz VSWR 1.35
<div data-bbox="129 344 531 394" style="border: 1px solid black; padding: 2px;">Interface</div> <p data-bbox="129 405 997 488">Standard MIL-STD-348B Mechanically compatible with 2.92 &amp; 3.5</p>	
<div data-bbox="129 607 531 656" style="border: 1px solid black; padding: 2px;">Electrical Data</div> <p data-bbox="129 667 1125 987">Impedance 50Ω Frequency Range DC To 18GHz VSWR ≤ 1.35 (DC To 18GHz) Insertion Loss ≤ 0.04 x √f(GHz) dB Insulation Resistance ≥ 5000MΩ Dielectric Withstanding Voltage (at sea level) 1500 V rms Working Voltage (at sea level) 500 V rms</p>	
<div data-bbox="129 1106 531 1155" style="border: 1px solid black; padding: 2px;">Mechanical Data</div> <p data-bbox="129 1167 949 1346">Recommended Coupling Nut Torque 4 in-lbs Coupling Proof Torque 5.3 in-lbs Contact Captivation-axial ≥ 6.1 lbs Durability (mating) ≥ 100</p>	
<div data-bbox="129 1509 531 1559" style="border: 1px solid black; padding: 2px;">Environmental Data</div> <p data-bbox="129 1570 1364 1794">Temperature Range -40°C to +80°C Thermal Shock MIL-STD-202, Method 107, Condition B Moisture Resistance MIL-STD-202, Method 206 Corrosion MIL-STD-202, Method 101, Condition B RoHS Compliant</p>	