

AD-A3PC7	SMA Plug to 7mm 18GHz VSWR 1.15	50Ω
----------	------------------------------------	-----

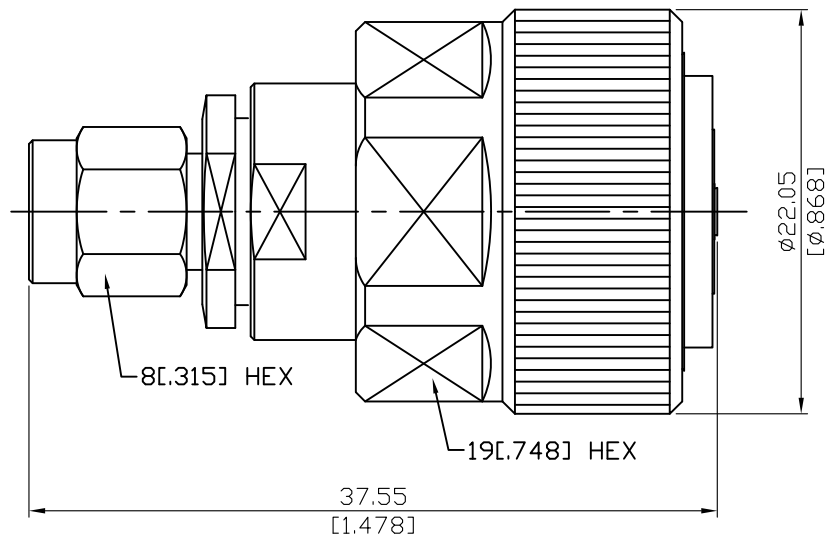

Parts	Material	Plating ( Micro-inch )
Retainer Ring	Beryllium Copper	Tin-Zinc-Copper-Alloy 100 Over Copper 50
Gasket	Silicone	
Insulator (SMA)	Teflon	
Insulator (7mm)	PPO	
Body	Brass	Tin-Zinc-Copper-Alloy 100 Over Copper 50
Coupling Nut (SMA)	Brass	Tin-Zinc-Copper-Alloy 100 Over Copper 50
Coupling Nut (7mm)	Stainless Steel	Passivated
Contact Pin (SMA)	Brass	Gold 4 Over Nickel-Phosphorus Alloy 80 Over Copper 20
Contact Pin (7mm)	Phosphor Bronze	Gold 4 Over Nickel-Phosphorus Alloy 80 Over Copper 20

--	--

This part number complies with RoHS.

Notice: JYEBAO reserves the right to make modifications deemed appropriate.

AD-A3PC7	SMA Plug to 7mm 18GHz VSWR 1.15													
<b>Interface</b> Standard Mechanically compatible with	<table border="1"> <thead> <tr> <th>SMA</th> <th>7mm</th> </tr> </thead> <tbody> <tr> <td>MIL-STD-348B</td> <td>IEC 457-2</td> </tr> <tr> <td>2.92 &amp; 3.5</td> <td></td> </tr> </tbody> </table>	SMA	7mm	MIL-STD-348B	IEC 457-2	2.92 & 3.5								
SMA	7mm													
MIL-STD-348B	IEC 457-2													
2.92 & 3.5														
<b>Electrical Data</b> Impedance Frequency Range VSWR Insertion Loss Insulation Resistance Dielectric Withstanding Voltage (at sea level) Working Voltage (at sea level)	<table> <tbody> <tr> <td>50Ω</td> </tr> <tr> <td>DC To 18GHz</td> </tr> <tr> <td>≤ 1.15 (DC To 18GHz)</td> </tr> <tr> <td>≤ 0.05 x √f(GHz) dB</td> </tr> <tr> <td>≥ 5000MΩ</td> </tr> <tr> <td>1500 V rms</td> </tr> <tr> <td>500 V rms</td> </tr> </tbody> </table>		50Ω	DC To 18GHz	≤ 1.15 (DC To 18GHz)	≤ 0.05 x √f(GHz) dB	≥ 5000MΩ	1500 V rms	500 V rms					
50Ω														
DC To 18GHz														
≤ 1.15 (DC To 18GHz)														
≤ 0.05 x √f(GHz) dB														
≥ 5000MΩ														
1500 V rms														
500 V rms														
<b>Mechanical Data</b> Recommended Coupling Nut Torque Coupling Proof Torque Coupling Nut Retention Force Contact Captivation-axial Durability (mating)	<table border="1"> <thead> <tr> <th>SMA</th> <th>7mm</th> </tr> </thead> <tbody> <tr> <td>4 in-lbs</td> <td>12 in-lbs</td> </tr> <tr> <td>5.3 in-lbs</td> <td>17.2 in-lbs</td> </tr> <tr> <td>≥ 60.7 lbs</td> <td>NA</td> </tr> <tr> <td>≥ 6.1 lbs</td> <td>≥ 6.3 lbs</td> </tr> <tr> <td>≥ 100</td> <td>≥ 5000</td> </tr> </tbody> </table>		SMA	7mm	4 in-lbs	12 in-lbs	5.3 in-lbs	17.2 in-lbs	≥ 60.7 lbs	NA	≥ 6.1 lbs	≥ 6.3 lbs	≥ 100	≥ 5000
SMA	7mm													
4 in-lbs	12 in-lbs													
5.3 in-lbs	17.2 in-lbs													
≥ 60.7 lbs	NA													
≥ 6.1 lbs	≥ 6.3 lbs													
≥ 100	≥ 5000													
<b>Environmental Data</b> Temperature Range Thermal Shock Moisture Resistance Corrosion RoHS	<table> <tbody> <tr> <td>-55°C to +105°C</td> </tr> <tr> <td>MIL-STD-202, Method 107, Condition B</td> </tr> <tr> <td>MIL-STD-202, Method 206</td> </tr> <tr> <td>MIL-STD-202, Method 101, Condition B</td> </tr> <tr> <td>Compliant</td> </tr> </tbody> </table>		-55°C to +105°C	MIL-STD-202, Method 107, Condition B	MIL-STD-202, Method 206	MIL-STD-202, Method 101, Condition B	Compliant							
-55°C to +105°C														
MIL-STD-202, Method 107, Condition B														
MIL-STD-202, Method 206														
MIL-STD-202, Method 101, Condition B														
Compliant														

Notice: JYEBAO reserves the right to make modifications deemed appropriate.

# AD-A3PC7

