

AD-A3F3

SMA Plug 50ohm To F Plug 75ohm  
(impedance mismatch)

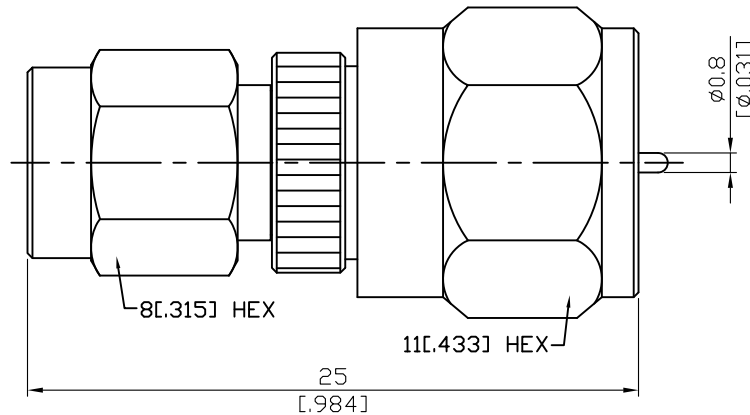

NOTE: Impedance Mismatch Causes Poor RF performance

Parts	Material	Plating ( Micro-inch )
Coupling Nut (SMA)	Brass	Gold 4 Over Nickel-Phosphorus Alloy 80 Over Copper 20
Coupling Nut (F)	Brass	Tin-Zinc-Copper-Alloy 100 Over Copper 50
Body (F)	Brass	Tin-Zinc-Copper-Alloy 100 Over Copper 50
Body (SMA)	Brass	Gold 4 Over Nickel-Phosphorus Alloy 80 Over Copper 20
Insulator	Teflon	
Contact Pin	Brass	Gold 4 Over Nickel-Phosphorus Alloy 80 Over Copper 20
Gasket	Silicone	
Retainer Ring	Beryllium Copper	Tin-Zinc-Copper-Alloy 100 Over Copper 50

This part number complies with RoHS.

Notice: JYEBAO reserves the right to make modifications deemed appropriate.

AD-A3F3	SMA Plug 50ohm To F Plug 75ohm (impedance mismatch)																			
<div style="border: 1px solid black; padding: 2px; margin-bottom: 5px;">Interface</div> Standard Mechanically Compatible With	<table border="1" style="width: 100%; border-collapse: collapse;"> <thead> <tr> <th style="width: 50%;">SMA</th> <th style="width: 50%;">F</th> </tr> </thead> <tbody> <tr> <td>MIL-STD-348B</td> <td>IEC 61169-24</td> </tr> <tr> <td>2.92 &amp; 3.5</td> <td></td> </tr> </tbody> </table>	SMA	F	MIL-STD-348B	IEC 61169-24	2.92 & 3.5														
SMA	F																			
MIL-STD-348B	IEC 61169-24																			
2.92 & 3.5																				
<div style="border: 1px solid black; padding: 2px; margin-bottom: 5px;">Electrical Data</div> Impedance Frequency Range VSWR Insulation Resistance Dielectric Withstanding Voltage (at sea level) Working Voltage (at sea level)	<table style="width: 100%;"> <tbody> <tr> <td style="width: 50%;">Impedance</td> <td colspan="2">50Ω (SMA) &amp; 75Ω (F)</td> </tr> <tr> <td>Frequency Range</td> <td colspan="2">DC To 3GHz</td> </tr> <tr> <td>VSWR</td> <td colspan="2">Poor (impedance mismatch)</td> </tr> <tr> <td>Insulation Resistance</td> <td colspan="2">≥ 5000MΩ</td> </tr> <tr> <td>Dielectric Withstanding Voltage (at sea level)</td> <td colspan="2">1500 V rms</td> </tr> <tr> <td>Working Voltage (at sea level)</td> <td colspan="2">500 V rms</td> </tr> </tbody> </table>		Impedance	50Ω (SMA) & 75Ω (F)		Frequency Range	DC To 3GHz		VSWR	Poor (impedance mismatch)		Insulation Resistance	≥ 5000MΩ		Dielectric Withstanding Voltage (at sea level)	1500 V rms		Working Voltage (at sea level)	500 V rms	
Impedance	50Ω (SMA) & 75Ω (F)																			
Frequency Range	DC To 3GHz																			
VSWR	Poor (impedance mismatch)																			
Insulation Resistance	≥ 5000MΩ																			
Dielectric Withstanding Voltage (at sea level)	1500 V rms																			
Working Voltage (at sea level)	500 V rms																			
<div style="border: 1px solid black; padding: 2px; margin-bottom: 5px;">Mechanical Data</div> Recommended Coupling Nut Torque Coupling Proof Torque Coupling Nut Retention Force Contact Captivation-axial Durability (mating)	<table border="1" style="width: 100%; border-collapse: collapse;"> <thead> <tr> <th style="width: 50%;"></th> <th style="width: 25%;">SMA</th> <th style="width: 25%;">F</th> </tr> </thead> <tbody> <tr> <td>Recommended Coupling Nut Torque</td> <td>4 in-lbs</td> <td>15 to 20 in-lbs</td> </tr> <tr> <td>Coupling Proof Torque</td> <td>5.3 in-lbs</td> <td>60 in-lbs</td> </tr> <tr> <td>Coupling Nut Retention Force</td> <td>≥ 60.7 lbs</td> <td>NA</td> </tr> <tr> <td>Contact Captivation-axial</td> <td>≥ 6.1 lbs</td> <td>NA</td> </tr> <tr> <td>Durability (mating)</td> <td>≥ 100</td> <td>≥ 500</td> </tr> </tbody> </table>			SMA	F	Recommended Coupling Nut Torque	4 in-lbs	15 to 20 in-lbs	Coupling Proof Torque	5.3 in-lbs	60 in-lbs	Coupling Nut Retention Force	≥ 60.7 lbs	NA	Contact Captivation-axial	≥ 6.1 lbs	NA	Durability (mating)	≥ 100	≥ 500
	SMA	F																		
Recommended Coupling Nut Torque	4 in-lbs	15 to 20 in-lbs																		
Coupling Proof Torque	5.3 in-lbs	60 in-lbs																		
Coupling Nut Retention Force	≥ 60.7 lbs	NA																		
Contact Captivation-axial	≥ 6.1 lbs	NA																		
Durability (mating)	≥ 100	≥ 500																		
<div style="border: 1px solid black; padding: 2px; margin-bottom: 5px;">Environmental Data</div> Temperature Range Thermal Shock Moisture Resistance Corrosion RoHS	<table style="width: 100%;"> <tbody> <tr> <td style="width: 50%;">Temperature Range</td> <td colspan="2">-65°C to +165°C</td> </tr> <tr> <td>Thermal Shock</td> <td colspan="2">MIL-STD-202, Method 107, Condition B</td> </tr> <tr> <td>Moisture Resistance</td> <td colspan="2">MIL-STD-202, Method 206</td> </tr> <tr> <td>Corrosion</td> <td colspan="2">MIL-STD-202, Method 101, Condition B</td> </tr> <tr> <td>RoHS</td> <td colspan="2">Compliant</td> </tr> </tbody> </table>		Temperature Range	-65°C to +165°C		Thermal Shock	MIL-STD-202, Method 107, Condition B		Moisture Resistance	MIL-STD-202, Method 206		Corrosion	MIL-STD-202, Method 101, Condition B		RoHS	Compliant				
Temperature Range	-65°C to +165°C																			
Thermal Shock	MIL-STD-202, Method 107, Condition B																			
Moisture Resistance	MIL-STD-202, Method 206																			
Corrosion	MIL-STD-202, Method 101, Condition B																			
RoHS	Compliant																			

Notice: JYEBAO reserves the right to make modifications deemed appropriate.