

AD-4.3/8-4.3/8-LP

LOW PIM 4.3-10 Jack To 4.3-10 Jack
IP67 Mated, 6GHz VSWR 1.1

50Ω

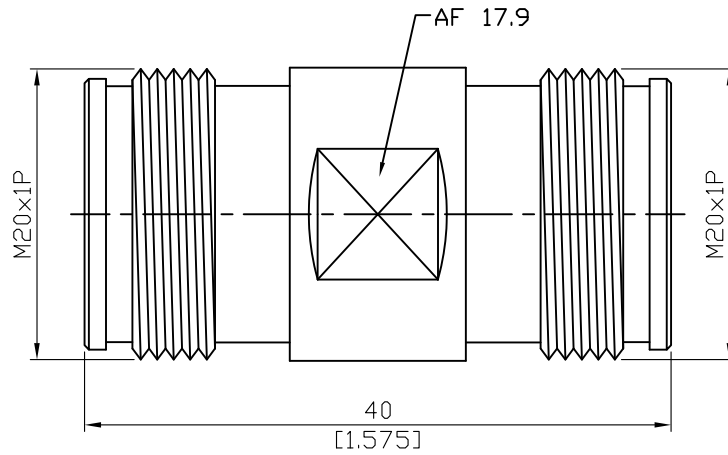

Intermodulation \geq 165 dBC

Parts	Material	Plating (Micro-inch)
Contact Pin	Phosphor Bronze	Gold 4 Over Nickel-Phosphorus Alloy 80 Over Copper 20
Insulator	Teflon	
Body	Brass	Tin-Zinc-Copper-Alloy 100 Over Copper 50
Contact Body	Phosphor Bronze	Tin-Zinc-Copper-Alloy 100 Over Copper 50

This part number complies with RoHS.

Notice: JYEBAO reserves the right to make modifications deemed appropriate.

AD-4.3/8-4.3/8-LP	LOW PIM 4.3-10 Jack To 4.3-10 Jack IP67 Mated, 6GHz VSWR 1.1																
<table border="0"> <tr> <td data-bbox="129 342 531 394">Interface</td> <td></td> </tr> <tr> <td data-bbox="129 394 531 533">Standard</td> <td data-bbox="531 394 1482 533">IEC 61169-54</td> </tr> </table>		Interface		Standard	IEC 61169-54												
Interface																	
Standard	IEC 61169-54																
<table border="0"> <tr> <td data-bbox="129 557 531 609">Electrical Data</td> <td></td> </tr> <tr> <td data-bbox="129 609 531 660">Impedance</td> <td data-bbox="531 609 1482 660">50Ω</td> </tr> <tr> <td data-bbox="129 660 531 712">Frequency Range</td> <td data-bbox="531 660 1482 712">DC to 6GHz</td> </tr> <tr> <td data-bbox="129 712 531 763">VSWR</td> <td data-bbox="531 712 1482 763">≤ 1.1 (DC To 6GHz)</td> </tr> <tr> <td data-bbox="129 763 531 815">Insertion Loss</td> <td data-bbox="531 763 1482 815">≤ 0.05 x √f(GHz) dB</td> </tr> <tr> <td data-bbox="129 815 531 866">Insulation Resistance</td> <td data-bbox="531 815 1482 866">≥ 5000MΩ</td> </tr> <tr> <td data-bbox="129 866 531 918">Dielectric Withstanding Voltage (at sea level)</td> <td data-bbox="531 866 1482 918">2500 V rms</td> </tr> <tr> <td data-bbox="129 918 531 969">Working Voltage (at sea level)</td> <td data-bbox="531 918 1482 969">500 V rms</td> </tr> </table>		Electrical Data		Impedance	50Ω	Frequency Range	DC to 6GHz	VSWR	≤ 1.1 (DC To 6GHz)	Insertion Loss	≤ 0.05 x √f(GHz) dB	Insulation Resistance	≥ 5000MΩ	Dielectric Withstanding Voltage (at sea level)	2500 V rms	Working Voltage (at sea level)	500 V rms
Electrical Data																	
Impedance	50Ω																
Frequency Range	DC to 6GHz																
VSWR	≤ 1.1 (DC To 6GHz)																
Insertion Loss	≤ 0.05 x √f(GHz) dB																
Insulation Resistance	≥ 5000MΩ																
Dielectric Withstanding Voltage (at sea level)	2500 V rms																
Working Voltage (at sea level)	500 V rms																
<table border="0"> <tr> <td data-bbox="129 1055 531 1106">Mechanical Data</td> <td></td> </tr> <tr> <td data-bbox="129 1106 531 1158">Recommended Coupling Nut Torque</td> <td data-bbox="531 1106 1482 1158">44 in-lbs (Screw Type)</td> </tr> <tr> <td data-bbox="129 1158 531 1209">Coupling Nut Torque</td> <td data-bbox="531 1158 1482 1209">70 in-lbs (Screw Type)</td> </tr> <tr> <td data-bbox="129 1209 531 1261">Contact Captivation-axial</td> <td data-bbox="531 1209 1482 1261">≥ 6.3 lbs</td> </tr> <tr> <td data-bbox="129 1261 531 1312">Durability (mating)</td> <td data-bbox="531 1261 1482 1312">≥ 100</td> </tr> </table>		Mechanical Data		Recommended Coupling Nut Torque	44 in-lbs (Screw Type)	Coupling Nut Torque	70 in-lbs (Screw Type)	Contact Captivation-axial	≥ 6.3 lbs	Durability (mating)	≥ 100						
Mechanical Data																	
Recommended Coupling Nut Torque	44 in-lbs (Screw Type)																
Coupling Nut Torque	70 in-lbs (Screw Type)																
Contact Captivation-axial	≥ 6.3 lbs																
Durability (mating)	≥ 100																
<table border="0"> <tr> <td data-bbox="129 1453 531 1505">Environmental Data</td> <td></td> </tr> <tr> <td data-bbox="129 1505 531 1556">Temperature Range</td> <td data-bbox="531 1505 1482 1556">-65°C to +165°C</td> </tr> <tr> <td data-bbox="129 1556 531 1608">Thermal Shock</td> <td data-bbox="531 1556 1482 1608">MIL-STD-202, Method 107, Condition B</td> </tr> <tr> <td data-bbox="129 1608 531 1659">Moisture Resistance</td> <td data-bbox="531 1608 1482 1659">MIL-STD-202, Method 206</td> </tr> <tr> <td data-bbox="129 1659 531 1711">Corrosion</td> <td data-bbox="531 1659 1482 1711">MIL-STD-202, Method 101, Condition B</td> </tr> <tr> <td data-bbox="129 1711 531 1762">RoHS</td> <td data-bbox="531 1711 1482 1762">Compliant</td> </tr> </table>		Environmental Data		Temperature Range	-65°C to +165°C	Thermal Shock	MIL-STD-202, Method 107, Condition B	Moisture Resistance	MIL-STD-202, Method 206	Corrosion	MIL-STD-202, Method 101, Condition B	RoHS	Compliant				
Environmental Data																	
Temperature Range	-65°C to +165°C																
Thermal Shock	MIL-STD-202, Method 107, Condition B																
Moisture Resistance	MIL-STD-202, Method 206																
Corrosion	MIL-STD-202, Method 101, Condition B																
RoHS	Compliant																

AD-4.3/8-4.3/8-LP

SoftPlot Measurement Presentation
VSWR S11

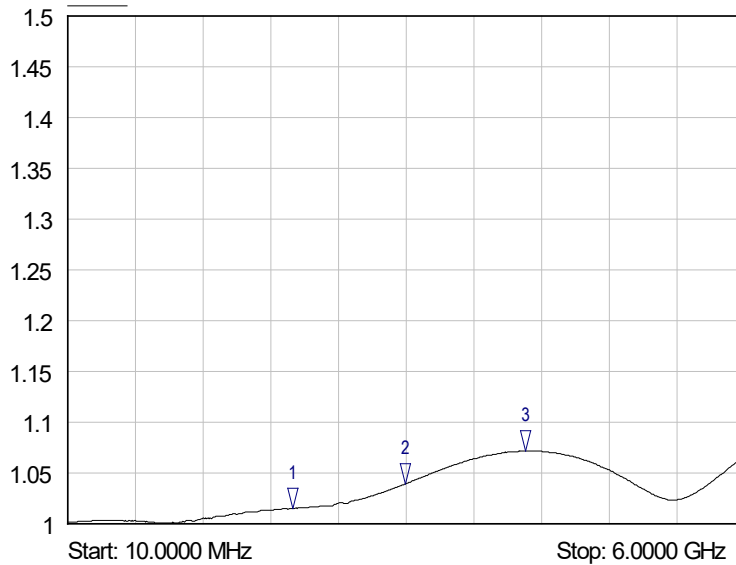

- 1 S11
▼ 2.0000 GHz
1.01 VSWR
- 2 S11
▼ 3.0000 GHz
1.04 VSWR
- 3 S11
▼ 4.0600 GHz
1.07 VSWR

PIM

