

7/16-3200B1-LDF4

7/16 Plug Clamp

50Ω

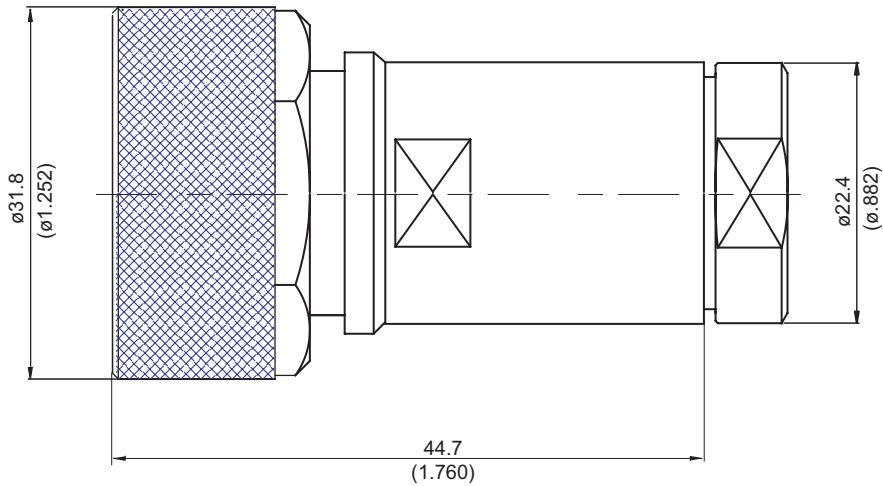

Parts	Material	Plating(Micro-inch)
Braid Clamp	Brass	Tin-Zinc-Copper-Alloy 100 Over Copper 50
Gasket	Silicon	
Contact Pin	Brass	Silver 150 Over Copper 50
Insulator	Teflon	
Body	Brass	Tin-Zinc-Copper-Alloy 100 Over Copper 50
Coupling Nut	Brass	Tin-Zinc-Copper-Alloy 100 Over Copper 50

Weight: 140.49 g

Suitable Cables: FSJ4-50B, RFF1/2"-50

This part number complies with RoHS.

Notice: JYEBAO reserves the right to make modifications deemed appropriate.

CABLE ASSEMBLY INSTRUCTION

7/16-3200B1-LDF4

JYE BAO CO., LTD.

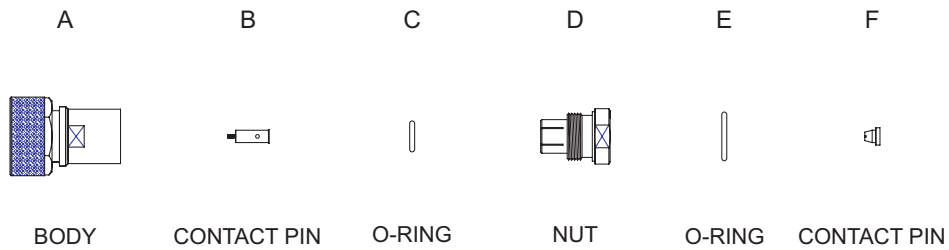

DIAGRAM	ASSEMBLY INSTRUCTION
	Step 1: STRIP AS SHOWN .
	Step 2: PUT VASELINE ON " C " AND SLIDE O-RING " C " OVER CABLE .
	Step 3: SLIDE NUT " D " OVER CABLE.
	Step 4: PUT VASELINE ON " E " AND SLIDE O-RING " E " OVER THE NUT " D " . Step 5: PUT 0.12 MM GAGE IN PLACE, INSERT CABLE'S CENTER CONDUCTOR INTO CENTER PIN " B " AND SOLDER IN " Y " .
	Step 6: SCREW " D " ON THE CONNECTOR BODY " A " .
	Step 7: FINALLY SCREW " F " ON CONTACT PIN " B " .

This part number complies with RoHS.

Notice: JYEBAO reserves the right to make modifications deemed appropriate.